



RIVERA PRIMO BRUTE IV EXTREME 2" TOURING OPEN BELT DRIVE

2 in. wide drive. 8 mm Kevlar® corded belt included with this kit was specifically designed to hold in excess of 150HP. 66-tooth ring gear for maximum torsional longevity. Features a modular heel-toe shifter linkage support so you don't have to figure out how to run your linkage as on other drives.

- Includes Primo® Pro Clutch
- Made in USA



HARLEY-DAVIDSON	Year	Description	Finish	Mfg/N	P/N	Retail
Touring	14-16	Belt Drive Kit	Polished	2016-0173	066103¹	2545.95
Touring	14-16	Belt Drive Kit	Black	2016-0174	066104¹	2583.95
FLHR	14-16	Belt Drive Kit	Black	2016-0172	066102	2632.50
FLHR	14-16	Belt Drive Kit	Polished	2016-0171	066101	2549.95
Touring	08-13	Belt Drive Kit	Polished	2016-0169	060418	2139.95
Touring	2007	Belt Drive Kit	Polished	2016-0126	060415	2139.95
Touring	08-13	Belt Drive Kit	Black	2016-0170	060448	2378.95
Touring	08-14	Front Pulley Kit		2026-0026	060469	239.95
Touring	08-14	Clutch Hub		2061-0015	060476	180.95

¹ exc. FLHR

Replacement Rear Basket

- Compatible with Brute IV™ Extreme 2" Touring Open Belt Drive

P/N	Retail
060456	375.95



060448



060415

RIVERA PRIMO BRUTE IV EXTREME 3" BELT DRIVE

3 in. wide drive, 8mm belt. Features a fully polished one-piece motor plate. Designed for bolt-on component pieces. Front and rear pulleys have bolt-on polished stainless flanges. Starter nose assembly conceals the jackshaft components.

- 3/8 in. thick billet aluminum outer guard
- Optional mounts for center-mount oil filter and mounts for mid-control shifting
- Includes a redesigned Pro Clutch™ assembly for maximum torque transference
- Made in USA



HARLEY-DAVIDSON	Year	Description	Finish	Mfg/N	P/N	Retail
Softail, Dyna	08-16	Belt Drive Kit	Polished	2016-0165	060417	2032.95
Softail, Dyna	08-16	Belt Drive Kit	Black	2016-0167	060449	2210.95
Softail	2007	Belt Drive Kit	Polished	2016-0155	060368	2032.95
Softail	2007	Belt Drive Kit	Black	2016-0157	060450	2185.95
Dyna	06-07	Belt Drive Kit	Polished	2016-0155	060368	2032.95
Dyna	06-07	Belt Drive Kit	Black	2016-0157	060450	2185.95
Softail	90-06	Belt Drive Kit	Polished	2016-0101	060390	1869.95
Softail	90-06	Belt Drive Kit	Black	2016-0107	060451	1919.95
Big Twin	90-06	Front Pulley Kit		2026-0061	060472	260.95
Big Twin	07-16	Front Pulley Kit		2026-0020	060468	241.95
Big Twin	90-06	Clutch Hub		2050-0049	060474	153.95
Big Twin	07-16	Clutch Hub		2061-0015	060476	180.95

Brute IV Extreme 3" Belt Drive Replacement Parts

Description	P/N	Retail
Replacement Clutch Pack Friction and Steels	060416	127.95
Replacement Basket	060459	381.95
Steel Plate (ea.)	060158	9.95
Pulley Screw (ea.)	060174	.95



060416



060390



060451

PRIMARY DRIVE



RIVERA PRIMO BRUTE IV 2" OPEN BELT DRIVE

Made narrow to fit as a bolt-on for Touring models with floorboards and FXR models with forward controls. Includes heel toe shifter support, which will unscrew from the motor plate for applications without floorboards. The outer center guard and cover are show chromed.

- Forged 6061 aluminum pulleys and motor plate
- Complete with installation instructions, Primo® Pro Clutch set-up, one-piece polished motor plate, jackshaft assembly and all hardware
- Made in USA



HARLEY-DAVIDSON	Year	Mfg/N	P/N	Retail
FLH	90-06	2016-0124	060414	2204.95
FXR	90-00	2016-0124	060414	2204.95

Brute IV 2" Open Belt Drive Pulley Screw

- Made in USA
- Sold individually



P/N	Retail
060174	.95



060438

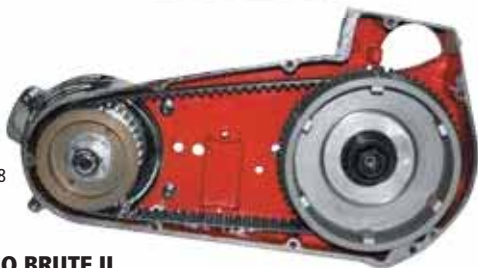

RIVERA PRIMO BRUTE II

EXTREME ENCLOSED PRIMARY BELT DRIVE

Designed for enclosed primary fitment within aluminum inner primaries or tin (stamped steel) primary covers. Features 1-1/2 in., 11 mm Kevlar® polychain belt. Uses O.E.M.-style dry clutches.

- Aluminum: 34 tooth front, 49 tooth rear
- Tin: 33 tooth front, 49 tooth rear
- Made in USA



Description	Mfg/N	P/N	Retail
37-54 4-Speed Tapered Shaft Motor Sprocket	2015-0002	060438	654.95
55-64 4-Speed Splined Shaft Motor Sprocket	2015-0003	060439	572.95
65-84 4-Speed Kickstart Models	2015-0004	060440	572.95
65-84 4-Speed Electric Start Models	2015-0005	060441	680.95

Brute II Extreme Belt Drive Replacement Parts

Description	P/N	Retail
Belt	060442	202.95
Rear Basket for P/N 060441	060460	585.95
Rear Basket for P/N 060440	060557	292.50
Front Pulley Kit for P/N 060440, 060441	060464	118.95



RIVERA PRIMO EARLY 8 MM 2 AND 3" WIDE OPEN KICKSTART BELT DRIVE

All pulleys are hard-anodized. Front pulleys are drilled and tapped to accept a puller for easy removal. All rear pulleys have hardened clutch dogs, which are attached with two stainless steel rivets in special slots in the basket.

- For use with O.E.M.-style stud and spring dry clutch or Primo® recommended Pro-Clutch™ P/N 060363
- Made in USA



HARLEY-DAVIDSON	Year	Size	Mfg/N	P/N	Retail
FL, FLH, FX	55-84	3 in.	2016-0217	060590¹	529.70
FL, FLH, FX	55-84	2 in.	2016-0215	060420¹	396.95
FL, FLH	36-54	3 in.	2016-0216	060419²	484.95
FL, FLH	36-54	2 in.	2016-0214	060421²	423.95

¹ With Splined Motor Shaft, 4-Speed Transmission

² With Tapered Motor Shaft

Kickstart Belt Drive Kit Replacement Parts

Description	Mfg/N	P/N	Retail
Belt Open 3" x 144 Teeth	BDL-37144-3	670316	100.55
3" Replacement Basket	2020-0035	060458	253.95
3" Front Pulley Kit	2026-0057	060471	142.95
2" Rubber Belt 144 Tooth	BDL-37144 2"	670314	71.69
2" Front Pulley Kit	2026-0050	060470	122.95
2" Replacement Basket	2020-0034	060457	199.95



RIVERA PRIMO BRUTE IV 3" OPEN BELT DRIVE KIT

3 in. open, electric start. Complete belt drive kit including motor plate.

- This kit has all necessary parts from 3 in. belt drive, complete Alto clutch assembly and motor plate with starter extension and hardware
- Has both styles of starter extension bolts
- Polished motor plate
- Made in USA



HARLEY-DAVIDSON	Year	Mfg/N	P/N	Retail
Softail	90-06	2016-0059	060371	2210.50

Brute IV 3" Open Belt Drive Kit Replacement Parts

Description	P/N	Retail
Belt Open 3" x 144 Teeth	670316	100.55
Clutch Pack	060427	132.95
Rear Basket	060455	299.95
Front Pulley Kit	060473	185.95

RIVERA PRIMO BRUTE III 8 MM 1-3/4" WIDE ENCLOSED BELT DRIVE

- Equipped with the Primo® Pro Clutch™
- Dry clutch basket/pulley assembly, which retains diaphragm function while increasing clutch area almost 100%
- Ideal for all street performance or competition applications
- Fits inside stock or aftermarket inner and outer primary covers
- Made in USA



HARLEY-DAVIDSON	Year	Mfg/N	P/N	Retail
FLH, FLT, FXR	94-06	2015-0030	060443¹	893.95
FLH, FXR	90-93	2015-0018	060444²	989.95
FLH, FXR	86-89	2015-0017	060445³	855.95
FXST, FLST	86-89	2015-0008	060164	755.50
FXSB, FXWG	84-86	2015-0016	060165	745.50

¹ includes 102 Tooth Starter Ring Gear

² models with Splined Trans Shaft and includes 66 Tooth Starter Ring Gear

³ models with Tapered Trans Shaft

Brute III 8 mm 1-3/4" Wide Replacement Parts

Description	P/N	Retail
Belt	060446	119.95
Clutch Hub for P/N 060444, 060443	060475	93.50
Clutch Pack	060427	132.95
Clutch Plate (ea.)	060172	11.95



060443

RIVERA PRIMO BRUTE III EXTREME ENCLOSED BELT DRIVES

Specifically designed for extreme shockloads generated by large displacement, highly modified American V-Twins.

- Includes Primo's® Pro Clutch™ Assembly
- 1-3/4 in. wide 11mm Kevlar® polychain belt is extremely durable
- 150+ HP capability
- Low maintenance
- Made in USA



HARLEY-DAVIDSON	Year	Teeth	Mfg/N	P/N	Retail
Softail	07-16	106T	2015-0065	060477	1182.95
Dyna	2006	106T	2015-0065	060477	1182.95
Twin Cam Softail, Dyna	00-06	102	2015-0055	060388¹	973.95
Softail, Dyna	94-99	102	2015-0051	060389	969.95
Softail, Dyna	94-99	84	2015-0053	060396	980.95
Softail, Dyna	90-93	66	2015-0050	060484	933.95

¹ exc. 2006 Dyna

Brute III Extreme Belt Drives Replacement Parts

Description	P/N	Retail
Belt for P/N 060477, 060388, 060389	060395	262.95
Replacement Clutch Pack Friction and Steels	060416	127.95
Rear Basket Only for P/N 060388, 060389	060463	202.95
Front Pulley Kit for P/N 060389	060467	123.95
Clutch Hub for P/N 060444, 060443	060475	93.50
Clutch Hub for P/N 060477	060560	167.50
Rear Basket for P/N 060477	060556	294.50
Front Pulley Kit for P/N 060477	060558	323.95
Front Pulley Kit for P/N 060388	060559	148.95
Clutch Plate (ea.)	060172	11.95



060477



060388

RIVERA PRIMO 8 MM 1-1/2" WIDE KICKSTART ONLY ENCLOSED BELT DRIVE

Includes front and rear pulleys, belt, front pulley nut, washer and guide (flange). Retain your stock inner and outer primary covers with these belt drive kits.

- Can be used with Pro Clutch P/N 060363, sold separately
- Made in USA



Description	Mfg/N	P/N	Retail
65-84 Big Twin with Splined Motor Shaft 4-Speed Aluminum Primary	2015-0012	060423	380.95
37-54 Big Twin with Tapered Motor Shaft 4-Speed Tin Primary	2015-0011	060422	399.95

Kickstart Only Belt Drive Replacement Parts

Description	P/N	Retail
Belt 132 Tooth	060424	84.95
Rear Basket for P/N 060423	060461	280.95
Rear Basket for P/N 060422	060462	282.50
Front Pulley Kit for P/N 060423	060465	105.95
Front Pulley Kit for P/N 060422	060466	106.95



060423

PRIMARY DRIVE



RIVERA PRIMO CLUTCH DOMES

Polished aluminum clutch domes improve the appearance of an open belt drive.

- Button head mounting bolts
- 4-stud dome fits Primo 8 mm open drive kits and Pro-Clutches
- Made in USA
- Mfg/N 1057-0020



P/N	Retail
060333	39.50



RIVERA PRIMO REPLACEMENT STARTER RING GEARS

For all Rivera Primo® belt drives. High-quality replacement starter ring gear kits for fitment on Rivera Primo® belt drive baskets.

- Made in USA



66-Tooth with Bolts

Description	Mfg/N	P/N	Retail
37-84 Model Brute, Brute Classic, Brute II, Brute II Classic Drives	2171-0015	060479	64.95
86-93 Model Brute III, Brute III Extreme Belt Drives	2171-0007	060480	104.95
86-93 Model Brute IV, IV Extreme, Brute V, Brute Force Belt Drives	2171-0009	060481	79.95

84-Tooth with Bolts

Description	Mfg/N	P/N	Retail
90-93 Model Brute III, Brute III Extreme Drives	2171-0002	060482	130.50

102-Tooth with Bolts

Description	Mfg/N	P/N	Retail
94-06 Model Brute III, Brute III Extreme Drives	2171-0004	060483	122.50

106-Tooth with Bolts

Description	Mfg/N	P/N	Retail
2006 Dyna; 07-15 Big Twin Models Brute III Extreme, Brute IV Extreme	2171-0016	060561	200.95

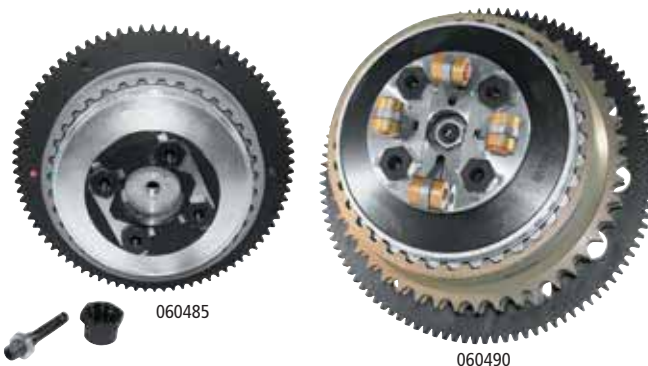

RIVERA PRIMO COMPLETE CHAIN DRIVE CLUTCH BASKETS WITH PRO-CLUTCH

If you are replacing the chain drive clutch basket or purchasing a basket for a ground-up project why not consider adding a top shelf, proven performer Rivera's Pro-Clutch™. Features forged aluminum baskets and complete Pro-Clutch™.

- Made in USA



Kits with Standard Pressure Plate

- P/N 060485 and 060486, 37 tooth sprocket, 84 tooth ring gear
- P/N 060487, 46 tooth sprocket, 106 tooth ring gear

HARLEY-DAVIDSON	Year	Mfg/N	P/N	Retail
Big Twin	07-16	1053-0022	060487	915.95
Big Twin	94-06	1053-0004	060486 ¹	781.95
Big Twin	90-93	1053-0003	060485	781.95
Dyna	2006	1053-0022	060487	915.95

¹ exc. 2006 Dyna

Kits with TPP Variable Pressure Clutch Assist

- P/N 060490, 46 tooth sprocket, 106 tooth ring gear

HARLEY-DAVIDSON	Year	Mfg/N	P/N	Retail
Big Twin	07-16	1053-0023	060490	994.95
Dyna	2006	1053-0023	060490	994.95

RIVERA PRIMO PINION GEARS FOR COMPLETE CHAIN DRIVE CLUTCH BASKETS WITH PRO-CLUTCH

- 10 tooth Pinion Gear



Application	Mfg/N	P/N	Retail
For use with 84 tooth Ring Gear on Big Twin Models (90-93)	1186-0020	060488	66.50
For use with 84 tooth Ring Gear on Big Twin (exc. 2006 Dyna) (94-06)	1186-0021	060489	71.50



RIVERA PRIMO TRANSPARAGUARD

Clear belt drive cover protects you from moving parts while showing off your belt drive. Made of polycarbonate; optically clear, UV- and shatter-resistant. The cover can be painted, machined, engraved or left clear as is.

- Fits Primo Brute IV Extreme Belt Drives or the Universal Transparaguard™ will fit any manufacturer's belt drives
- Made in USA



Description	P/N	Retail
Transparaguard™ for Brute IV	060225	298.95
Transparaguard™ - Universal 3" Open Belt Drive	060227	216.95



RIVERA PRIMO SPECIAL ACORN MOTOR NUTS FOR ALL OFFSET INSERTS

- Made in USA



Description	Mfg/N	P/N	Retail
Standard Splined Nut	2019-0008	060428	4.50
Nut for 1/2" Offset Insert	2019-0010	060429	14.50
Nut for 3/4" Offset Insert	2019-0006	060430	22.95
Nut for 1" Offset Insert	2019-0003	060431	22.95
Nut for 1-1/4" Offset Insert	2019-0004	060432	23.95
Nut for 1-1/2" Offset Insert	2019-0001	060433	30.95
Nut for 1-3/4" Offset Insert	2019-0002	060434	49.95
Nut for 2" Offset Insert	2019-0007	060435	49.95



RIVERA PRIMO EARLY MODEL BELT GUARD ASSEMBLY

Belt guard assembly with chrome steel top shroud and polished aluminum side cover.

- 14-gauge steel
- Slotted side cover
- Made in USA



HARLEY-DAVIDSON	Year	P/N	Retail
Big Twin	70-84	060341	149.95
Big Twin	37-69	060436	125.95



RIVERA PRIMO STARTER JACKSHAFTS

- Fits all Rivera Primo open belt drives up to 2006 Big Twin (exc. 2006 Dyna)
- Made in USA



Mfg/N	P/N	Retail
2185-0001	060550	163.95



RIVERA PRIMO PULLEY SHIMS

Accurately align front belt drive pulleys. Spacers are 1008-1010 steel, precision-ground for perfectly parallel and flat surfaces to ensure perfect pulley alignment.

- Package includes one each of .020, .030, .050, .075 and .100 in. shims
- Made in USA
- For use with Primo belt drive kits



P/N	Retail
060575	13.95



RIVERA PRIMO INSERTS FOR 3 AND 3-1/2" WIDE FRONT PULLEYS

Inserts sold without pulley or hardware. When ordering offset inserts separately, remember to add the built-in amount of offset Primo® has calculated for each model. Twin Cam Softail 0.750 in., Evolution Softail, Dyna 0.500 in., FXR 0.625 in. and Panhead/Shovelhead 0.375 in. Add this number to the offset number you have calculated.

- Made in USA



Description	Mfg/N	P/N	Retail
Stock	2019-0153	060425	51.95
.250"	2019-0114	060400	51.95
.500"	2019-0120	060401	71.95
.750"	2019-0130	060402	78.95
1.00"	2019-0109	060403	85.95
1.25"	2019-0116	060404	92.95
1.50"	2019-0118	060405	113.95
1.75"	2019-0126	060406	84.95
2.00"	2019-0127	060407	84.95

RIVERA PRIMO CLUTCH BASKET BEARING

Double-row ball bearing.

- Mfg/N 1018-0015
- Fits all H-D® models
- Made in USA



Mfg/N	P/N	Retail
1018-0015	060426	56.50



RIVERA PRIMO WASHER FOR SPLINED FRONT PULLEYS

For the Primo belt guide. Washer is specially designed to go with the belt guide to keep it mounted to the bike.

- Made in USA



HARLEY-DAVIDSON	Year	Mfg/N	P/N	Retail
Big Twin	84-99	1100-0160	060159	1.00



AUDIO, VIDEO & NAVIGATION

INDIAN & VICTORY

WINDSHIELDS

SEATS & Sissy BARS

LUGGAGE

SECURITY & COVERS

TIRES & WHEELS

BRAKES

CHASSIS

SUSPENSION

SHEET METAL

EXHAUST

FUEL & AIR SYSTEMS

ENGINE & OIL FILTERS

PRIMARY DRIVE

TRANSMISSION & FINAL DRIVE

GASKETS & HARDWARE

HANDLEBARS & CONTROL

CABLES

FOOT CONTROL

INSTRUMENT & LIGHTING

ELECTRICAL

BATTERIES & CHARGERS

TRAILERS & RAMPS

CHEMICALS & LUBES

TOOLS & SUPPLIES

GENERAL ACCESSORIES & DISPLAY

CROSS REFERENCE

INDEX

PRIMARY DRIVE

AUDIO, VIDEO
& NAVIGATION

INDIAN
& VICTORY

WINDSHIELDS

SEATS &
SISSY BARS

LUGGAGE

SECURITY
& COVERS

TIRES &
WHEELS

BRAKES

CHASSIS

SUSPENSION

SHEET METAL

EXHAUST

FUEL & AIR
SYSTEMS

ENGINE &
OIL FILTERS

PRIMARY DRIVE

TRANSMISSION
& FINAL DRIVE

GASKETS &
HARDWARE

HANDLEBARS
& CONTROL

CABLES

FOOT
CONTROL

INSTRUMENT
& LIGHTING

ELECTRICAL

BATTERIES &
CHARGERS

TRAILERS
& RAMPS

CHEMICALS
& LUBES

TOOLS &
SUPPLIES

GENERAL
ACCESSORIES
& DISPLAY

CROSS
REFERENCE

INDEX



BELT DRIVES LTD. 2" DRIVE FOR SOFTTAILS AND BAGGERS

Loaded with style to accommodate today's trends. All billet construction with unique top guard.

- Includes BDL's popular ball bearing clutch for ease of shifting and performance
- All kits include black top belt guard
- Includes three different dome covers to allow for four different looks in one kit
- The three domes are chrome, black and polished
- Made in USA



HARLEY-DAVIDSON	Year	Finish	Mfg/N	P/N	Retail
Baggers	07-13	Black	EVO-14B-2B	439250	2398.95
Baggers	07-13	Chrome	EVO-14B-2C	439251	2579.95
Softail	07-16	Black	EV-725B	439248	2398.95
Softail	07-16	Chrome	EV-725C	439249	2579.95
Softail	90-06	Black	EV-700B	439247	2398.95
Softail	90-06	Polished	EV-700P	439246	2249.95



438905



438910



438906



438912

BELT DRIVES LTD. 2" OPEN BELT DRIVE

Design includes a 52 tooth front pulley and 69 tooth rear pulley, both 2 in. wide and driven with a specially designed 142 tooth belt. One-piece polished billet motor plate. Ball bearing pressure plate.

- Made in USA



Polished

HARLEY-DAVIDSON	Year	Mfg/N	P/N	Retail
Softail	07-16	EVO-8S	439039¹	1875.03
Softail	07-16	EVO-8S-2	438905	1875.03
Softail	90-06	EVO-575	438910	1578.98
Dyna	06-16	EVO-8S	439039¹	1875.03
Dyna	06-16	EVO-8S-2	438905	1875.03
Big Twin	70-78	SH-500	438926	1578.98

Black

HARLEY-DAVIDSON	Year	Mfg/N	P/N	Retail
Softail	07-16	EVO-8S-2B	438906	2023.06
Softail	90-06	EV-575-B	438912	1727.01
Dyna	06-16	EVO-8S-2B	438906	2023.06

¹ 2-3/4" wide

Replacement Parts for EVO-8S-2/2B 2" Open Belt Drive
2" Open Belt Drive replacement parts for P/N'S 438905 and 438906

Description	Mfg/N	P/N	Retail
52T Front Pulley	52F-2	439205	119.50
69T Rear Basket	69EV2-4	439206	333.95
C-Clip (back of clutch hub)	CC-158	439207	1.59
Belt - 142T	BDL-142-2	439208	111.95
Clutch Hub	EV-180	439046	111.72

Replacement Parts for EVO-575/B 2" Open Belt Drive
2" Open Belt Drive replacement parts for P/N'S 438910 and 438912

Description	Mfg/N	P/N	Retail
52T Front Pulley	EV-52	439209	117.50
69T Rear Basket	69EV-2	439210	335.95
Clutch Hub	EV-180	439046	111.72
Belt - 142T	BDL-142-2	439208	111.95

Replacement Parts for SH500 2" Open Belt Drive
2" Open Belt Drive Replacement Parts for P/N 438926

Description	Mfg/N	P/N	Retail
Belt - 142T	BDL-142-2	439208	111.95
52T Front Pulley	EV-52	439209	117.50
69T Rear Basket	69EV-2	439210	335.95



BELT DRIVES LTD. 2" OPEN BELT DRIVE FOR BAGGERS

Designed to allow proper stock placement of the floorboards. Incorporates a unique top belt guard into the system, which fits in a groove between the motor plate and side guard. New pulley ratio that affords great overall RPM management.

- Includes BDL's patented Ball Bearing Lock Up Clutch
- Made in USA



Polished

HARLEY-DAVIDSON	Year	Mfg/N	P/N	Retail
FLT	07-13	EVO-13B-2	438907	2072.41
FXR, FLT, FLH	90-06	EVO-11S-2	438909	2072.41

Black

HARLEY-DAVIDSON	Year	Mfg/N	P/N	Retail
FLT	07-13	EVO-13B-2B	438908	2220.44
FXR, FLT, FLH	90-06	EVO-11S-2B	438914	2220.44



438907

438908

Replacement Parts for EVO-13B-2/2B 2" Open Belt Drive for Baggers

- 2" open belt drive replacement parts for FLT
- Compatible with P/N 438907 and 438908

Description	Mfg/N	P/N	Retail
52T Front Pulley	B52F-2	439200	119.50
69T Rear Basket	B69-EV4	439201	333.95
Clutch Hub	EV-180	439046	111.72
Belt - 132T	BDL-132B-KG	439202	109.00

Replacement Parts for EVO-11S-2/2B 2" Open Belt Drive for Baggers

- 2" open belt drive replacement parts for Evo-11S-2B
- Compatible with P/N 438909 and 438914

Description	Mfg/N	P/N	Retail
52T Front Pulley	B52-EV	439203	119.50
69T Rear Basket	B69-EV3	439204	333.95
Clutch Hub	EV-180	439046	111.72
Belt - 132T	BDL-132B-KG	439202	109.00



438927



438999

BELT DRIVES LTD. 3" BELT DRIVE ELECTRIC START

Polished aluminum motor plate with starter housing.

- Made in USA



HARLEY-DAVIDSON	Year	Mfg/N	P/N	Retail
Softail	90-06	EVO-9S	438999	1517.53
Dyna	91-05	EVO-12S	438927	1774.49
FXR	90-06	EVO-11S-A	438998	1774.49
Big Twin	70-78	EVO-10S	438933 ¹	1774.49

¹ models using 90-Up Big Twin Starter

Replacement Belts for 3" Belt Drive Electric Start

Description	Mfg/N	P/N	Retail
8 mm 3" 132 Tooth 72-48 for P/N 438998	BDL-132-3	438996	100.55
8 mm 3" 141 Tooth 72-47 for P/N 438999	BDL-141-3	438997	100.55



438992

438994

438967

438993

438995

438968

Replacement Parts for 3" Belt Drive Electric Start

Description	Mfg/N	P/N	Retail
Starter Housing – Softail, FXR, Dyna	SH-9	438962	131.95
Hardware Kit – Softail, FXR	HK-9	438963	55.86
Motor Plate Bearing – Softail, FXR, Dyna	MPB-9	438964	55.86
Side Plate – Softail, Dyna	SP-9	438965	78.20
Starter Pinion Gear – Softail, FXR, Dyna	PG-100	438966	55.86
Starter Gear - All Applications	SG-2	438939	44.69
3" Basket, Gear, Dogs & Bearing – Softail, FXR, Dyna	72-3E	438935	334.23
Round Dogs (Set of 12) Softail, FXR, 5-Speed Shovel	EVRD-1	439045	40.03
Clutch Hub	EV-180	439046	111.72
Step Washer for Hub	ESW-1	439047	3.33
C-Clip for Hub Bearing	CC-244	439048	3.33
C-Clip for Step Washer	CC-134	439049	2.65
Hub Nut with Seal (90-Up only)	HNS-100	439052	14.29
Basket Hub Bearing	EHB-100	439053	44.69
Shoulder Bolts (Set of 6)	ESB-100	439117	21.43
Clutch Springs (Set of 6)	ECS-100	439118	21.43
Clutch Steel for Round Dog Clutch	ERDS-100	438993	14.29
Splined Clutch Steel (Backing Plate)	EDP-200	438992 ¹	14.29
1-Sided Kevlar® Clutch Plates	ECP-100	438994	17.14
2-Sided Kevlar® Clutch Plates	ECP-200	438995	17.14
Quiet Clutch Friction Plates (Set of 7)	ERCP-100	438967 ¹	105.20
Quiet Clutch Steel Plates (Set of 7)	ERCS-100	438968 ¹	34.95

¹ Order 438992, 438967, 438968 to make complete kit.

PRIMARY DRIVE

AUDIO, VIDEO
& NAVIGATION

INDIAN
& VICTORY

WINDSHIELDS

SEATS &
SISSY BARS

LUGGAGE

SECURITY
& COVERS

TIRES &
WHEELS

BRAKES

CHASSIS

SUSPENSION

SHEET METAL

EXHAUST

FUEL & AIR
SYSTEMS

ENGINE &
OIL FILTERS

PRIMARY DRIVE

TRANSMISSION
& FINAL DRIVE

GASKETS &
HARDWARE

HANDLEBARS
& CONTROL

CABLES

FOOT
CONTROL

INSTRUMENT
& LIGHTING

ELECTRICAL

BATTERIES &
CHARGERS

TRAILERS
& RAMPS

CHEMICALS
& LUBES

TOOLS &
SUPPLIES

GENERAL
ACCESSORIES
& DISPLAY

CROSS
REFERENCE

INDEX



BELT DRIVES LTD. 3" BELT DRIVE WITH OUTBOARD BEARING SUPPORT

Complete kit including pulleys, belt and outboard support. Outboard support keeps the transmission from flexing.

- Polished
- Mfg/n EVO-900
- Made in USA



HARLEY-DAVIDSON	Year	Mfg/N	P/N	Retail
FXST, FLST	90-06	EVO-900	438959	2038.89



BELT DRIVES LTD. REPLACEMENT OUTBOARD BEARING

Replacement outboard bearings only, found in BDL belt drive systems.

- Made in USA



P/N	Retail
438846	17.00



438940



438942

BELT DRIVES LTD. PULLEY AND INSERTS FOR 3" ELECTRIC START

Description	P/N	Retail
Standard Insert and Nut	438960	67.03
1/4" Insert and Special Nut	438942	67.03
1/2" Insert and Special Nut	438943	67.03
3/4" Insert and Special Nut	438944	67.03
1" Insert and Special Nut	438945	67.03
1-1/4" Insert and Special Nut	438946	67.03
1-1/2" Insert and Special Nut	438947	67.03
1-3/4" Insert and Special Nut	438948	67.03
2" Insert and Special Nut	438949	67.03
3" 47 Tooth Pulley (For Softail Only)	438940	111.72



BELT DRIVES LTD. CHAIN DRIVE KIT

Complete chain drive kit featuring BDL's ball-bearing lockup clutch for riders who want a lighter, easier to operate clutch. Provides approximately 60% more surface contact area than stock clutch for smooth, sure power transfer to the rear wheel.

- Complete kit includes rear basket with BDL ball-bearing clutch, front 25-tooth sprocket, Diamond primary chain and adjuster assembly
- Includes BDL's patented compensator
- Made in USA



HARLEY-DAVIDSON	Year	P/N	Retail
FXST, FLST	90-06	438838	887.50
FXD	91-05	438838	887.50



BELT DRIVES LTD. 8 MM 1-1/2" CLOSED PRIMARY BELT DRIVE

No more extensive grinding on inner primary with this bolt-in belt drive.

- Kevlar® clutch plates
- Kevlar® belt included
- Fits electric start models
- Made in USA



HARLEY-DAVIDSON	Year	Mfg/N	P/N	Retail
FXST, FLST	07-16	EVB-8SL	439141¹	838.83
FXST, FLST	90-06	EVBB-2SL	439076²	694.99
Big Twin	79-83	EVBB-3T-5	439038³	694.99
Big Twin	70-83	EVBB-3T-4	438990⁴	694.99

¹ ball bearing lock-up clutch

² models with splined clutch hub, 68-45 pulleys, ball bearing clutch

³ 5-Speed models with rear chain drive, 68-47 pulleys

⁴ 4-Speed models With rear chain drive, 68-45 pulleys

Replacement Belts for 8 mm 1-1/2" Closed Primary

Description	Mfg/N	P/N	Retail
8 mm x 42 mm 130 Tooth for P/N 438989	BDL-130K	439080	93.10
1-1/2" Wide 138 Tooth Kevlar® Belt	BDL-138-38K	439081	93.10
8 mm x 41 mm 138 Tooth for P/N 438991, 439076	BDL-138K	439077	93.10
8 mm x 1-1/2" 142 tooth for P/N 439141	BDL-142	439142	111.72

Replacement Parts 8 mm 1-1/2" Closed Primary

Description	Mfg/N	P/N	Retail
Round Dogs (Set of 12) Softail, FXR, 5-Speed Shovel	EVRD-1	439045	40.03
Clutch Hub	EV-180	439046	111.72
Step Washer for Hub	ESW-1	439047	3.33
C-Clip for Hub Bearing	CC-244	439048	3.33
C-Clip for Step Washer	CC-134	439049	2.65
Hub Nut with Seal (90-Up only)	HNS-100	439052	14.29
Basket Hub Bearing	EHB-100	439053	44.69
Rear Basket Softail, FXR, 5-Speed Shovelhead	EV-475	439054²	221.58
Clutch Steel for Round Dog Clutch	ERDS-100	438993	14.29
Splined Clutch Steel Plate	EDP-200	438992¹	14.29
Quiet Clutch Plates (Set of 7)	ERCP-100	438967¹	105.20
Quiet Clutch Steel Plates (Set of 7)	ERCS-100	438968¹	34.95
1-Sided Kevlar® Clutch Plates	ECP-100	438994	17.14
2-Sided Kevlar® Clutch Plates	ECP-200	438995	17.14

¹ Order 438992, 438967, 438968 to make complete kit.

² Includes starter gear, dogs and bearing.

BELT DRIVES LTD. 8 MM 1-5/8" BELT DRIVE

Direct bolt-in applications. System now comes with the Quiet Clutch system. Precision-machined, polished aluminum pressure plate uses nine springs and shoulder bolts to ensure even spring pressure (included in kit). Rear pulley has a 40 mm, double-row bearing with an inner stress-proof steel clutch hub to support the clutch.

Replacement components available separately

- Does not include motor plate or starter provisions
- Made in USA

Includes:

Front pulley

Belt

Clutch hub

Clutch hub basket

Kevlar® clutch set (consists of two half plates, four full plates and five steel five plates)



HARLEY-DAVIDSON	Year	P/N	Retail
FLH, FLT, FXR	86-89	438842	694.99
FLH, FLT, FXR	79-84	438843	694.99
FXST, FLST	90-06	438991¹	694.99

¹ models with pinion gear, 68-45 pulleys, spring clutch



438842

PRIMARY DRIVE

AUDIO, VIDEO
& NAVIGATION

INDIAN
& VICTORY

WINDSHIELDS

SEATS &
SISSY BARS

LUGGAGE

SECURITY
& COVERS

TIRES &
WHEELS

BRAKES

CHASSIS

SUSPENSION

SHEET METAL

EXHAUST

FUEL & AIR
SYSTEMS

ENGINE &
OIL FILTERS

PRIMARY DRIVE

TRANSMISSION
& FINAL DRIVE

GASKETS &
HARDWARE

HANDLEBARS
& CONTROL

CABLES

FOOT
CONTROL

INSTRUMENT
& LIGHTING

ELECTRICAL

BATTERIES &
CHARGERS

TRAILERS
& RAMPS

CHEMICALS
& LUBES

TOOLS &
SUPPLIES

GENERAL
ACCESSORIES
& DISPLAY

CROSS
REFERENCE

INDEX



BELT DRIVES LTD. 11 MM 1-1/2" PRIMARY BELT DRIVES

The latest in 11mm primary belt drives features a special Gates® belt. Additional teeth on both front and rear pulleys increase belt wrap, improve durability and lengthen belt life.

- Made in USA



With Idler Bearing

HARLEY-DAVIDSON	Year	Mfg/N	P/N	Retail
Big Twin	65-E84	47-31 SE-4	438984¹	366.81

¹ electric start 4-speed models with rear chain

Without Idler Bearing

HARLEY-DAVIDSON	Year	Mfg/N	P/N	Retail
Big Twin	55-64	47-31 SK-2	438986²	288.61

² kick start models with splined sprocket shaft

11 mm 1-1/2" Primary Belt Drives Replacement Belts

Description	Mfg/N	P/N	Retail
Closed 1-1/2" x 99 Teeth	BDL-1185	438896	55.86



BELT DRIVES LTD. 8 MM 1-1/2" BELT DRIVE

Most belt drive enthusiasts still think that these units are the best size and combination for all around riding and dependability. This drive adapts your stock clutch directly into the basket or you can upgrade your clutch to Belt Drives Ltd. Competitor Clutch for 30% more clutch surface than stock.

- For electric start models
- Made in USA



HARLEY-DAVIDSON	Year	Mfg/N	P/N	Retail
Big Twin	79-84	61-41-RB	438827²	393.99
Big Twin	79-84	61-41-SE-2	438828¹	393.99
Big Twin	79-84	61-41-SK-4	438829³	299.99
Big Twin	65-78	62-40-SK-3	438832³	299.99
Big Twin	65-78	61-41-SE-1	438916¹	393.99
Big Twin	55-64	62-39-SK-2	438830³	299.99
Big Twin	37-54	62-39-TK-1	438831³	299.99

¹ rear chain models

² rear belt models

³ kick start models

Replacement Parts for 8 mm 1-1/2" Belt Drive

Description	Mfg/N	P/N	Retail
1-1/2" Wide 99 Tooth Belt for 438916	BDL-30853 ST	438898	50.27
Outer Belt Guide	OBG-1	438981	6.67
Inner Belt Guide	IBG-1	438982	5.00



BELT DRIVES LTD. 8 MM 1-1/2" BOLT-IN BELT DRIVE

- One of the original closed primary belt drives designed for bolt-in application
- Clutch basket features 12 cylindrical replaceable clutch dogs, which allows clutch plates to maintain constant contact
- Kevlar® clutch plates included for maximum performance
- Polished pressure plate uses nine shoulder bolts and springs so you can adjust your clutch pressure by simply removing or adding springs and shoulder bolts
- Made in USA



HARLEY-DAVIDSON	Year	Mfg/N	P/N	Retail
FLH	70-83	EVB-3T-4	438961¹	651.00
FX	71-83	EVB-3T-4	438961¹	651.00

¹ 4-speed models with rear chain only

Replacement Parts for 8 mm 1-1/2" Bolt-In Belt Drive

Description	Mfg/N	P/N	Retail
1-1/2" Wide 138 Tooth Kevlar® Belt	BDL-138-38K	439081	93.10
Shoulder Bolts (Set of 6)	ESB-100	439117	21.43
Clutch Springs (Set of 6)	ECS-100	439118	21.43
Inner Hub	EV-160	439213	111.95
C-Clip (back of clutch hub)	CC-158	439207	1.59
45T Front Pulley	45EVSH	439214	100.50
68T Rear Basket	EV-460	439215	221.50



BELT DRIVES LTD. 8 MM 2" BELT DRIVE FOR STOCK CLUTCH

Made from 356-T6 aluminum. All pulleys are cast in Belt Drives Ltd. foundry and completely machined in-house.

- Uses stock H-D® 3-stud clutch hub
- Includes a big fix bearing kit with each belt drive
- Made in USA



Harley-Davidson	Year	Mfg/N	P/N	Retail
FLH	55-84	76-47-2S	438938¹	395.99
FX	71-84	76-47-2S	438938¹	395.99

¹ Kick start models only

Replacement Parts for 8 mm 2" Belt Drive for Stock Clutch

- For P/N 438938 8mm 2" belt drive system

Description	Mfg/N	P/N	Retail
2" Rubber Belt 144 Tooth	BDL-37144 2"	670314	71.69
47T Front Pulley	47S-2	439216	100.50
76T Kick Only 2" Basket	76K-2	439217	254.95



BELT DRIVES LTD. 8 MM 3" BELT DRIVE KICK START

Quality 356T6 cast pulley. CNC-machined and hard-anodized.

- Big Fix bearing kit included
- Made in USA



Description	Mfg/N	P/N	Retail
55-84 Splined Engine Shaft	76-47 3S	438978	421.74

Replacement Parts for 8 mm 3" Belt Drive Kick Start

Description	Mfg/N	P/N	Retail
Belt Open 3" x 144 Teeth	BDL-37144-3	670316	100.55
47 Tooth Front Pulley	47S-3	439211	111.95
76T Kick Only Basket	76K-3	439212	310.95



BELT DRIVES LTD. 8 MM 3" BELT DRIVE

All pulleys are cast in Belt Drives Ltd. foundry and completely machined in-house.

- Made out of 356-T6 aluminum
- These drives are supplied with the Competitor Clutch and spring pressure plate
- Made in USA



HARLEY-DAVIDSON	Year	Description	P/N	Retail
FLH	55-84	Competitor Clutch	438973 ¹	775.50
FX	71-84	Competitor Clutch	438973 ¹	775.50
FLH	55-84	Ball Bearing Lock-Up Clutch	438936 ¹	776.45
FX	71-84	Ball Bearing Lock-Up Clutch	438936 ¹	776.45

¹ Kick start only

Replacement Parts for 8 mm 3" Belt Drive

Description	Mfg/N	P/N	Retail
Belt Open 3" x 144 Teeth	BDL-37144-3	670316	100.55
47 Tooth Front Pulley	47S-3	439211	111.95
76T Kick Only Basket	76K-3	439212	310.95
Shoulder Bolts (Set of 6)	ESB-100	439117	21.43
Clutch Springs (Set of 6)	ECS-100	439118	21.43
Standard Insert and Nut	IN-STD	438960	67.03
C-Clip (back of clutch hub)	CC-158	439207	1.59



BELT DRIVES LTD. 3" BELT DRIVE COVER

- Chrome
- Cover can be used with 438975 domes that are supplied with 3 in. belt drives from BDL

Note: Cannot be used as a bearing support.

Mfg/N	P/N	Retail
BDC-4C	438931	421.74



BELT DRIVES LTD. REPLACEMENT BELT GUIDES

Replacement belt guides for front pulley belt drives.

- Made in USA



Inner

HARLEY-DAVIDSON	Year	Mfg/N	P/N	Retail
Big Twin	70-E84	IBG-1	438982	5.00

Outer

HARLEY-DAVIDSON	Year	Mfg/N	P/N	Retail
Big Twin	55-E84	OBG-1	438981	6.67



BELT DRIVES LTD. BELT DRIVE DOME COVERS

Polished, two-piece dome cover set.

- Includes special tape for easy on/off installation
- For 3 in. belt drive kits (3 in. Belt Drives Ltd. kits)
- Fits 47T and 72T
- Made in USA



P/N	Retail
438975	55.86

PRIMARY DRIVE

AUDIO, VIDEO
& NAVIGATION

INDIAN
& VICTORY

WINDSHIELDS

SEATS &
SISSY BARS

LUGGAGE

SECURITY
& COVERS

TIRES &
WHEELS

BRAKES

CHASSIS

SUSPENSION

SHEET METAL

EXHAUST

FUEL & AIR
SYSTEMS

ENGINE &
OIL FILTERS

PRIMARY DRIVE

TRANSMISSION
& FINAL DRIVE

GASKETS &
HARDWARE

HANDLEBARS
& CONTROL

CABLES

FOOT
CONTROL

INSTRUMENT
& LIGHTING

ELECTRICAL

BATTERIES &
CHARGERS

TRAILERS
& RAMPS

CHEMICALS
& LUBES

TOOLS &
SUPPLIES

GENERAL
ACCESSORIES
& DISPLAY

CROSS
REFERENCE

INDEX



BELT DRIVES LTD. PRIMARY SPACERS

HARLEY-DAVIDSON	Year	Description	P/N	Retail
FLH, FXST, FLST, FXD, FXR	84-06	1/4" Spacer	438950¹	31.65
FLH, FXST, FLST, FXD, FXR	84-06	1/2" Spacer	438951¹	37.24
FLH, FXST, FLST, FXD, FXR	84-06	3/4" Spacer	438952¹	44.69
FLH, FXST, FLST, FXD, FXR	84-06	1" Spacer	438953¹	55.86
FLH, FXST, FLST, FXD, FXR	84-06	1-1/4" Spacer	438954¹	71.69
FLH, FXST, FLST, FXD, FXR	84-06	1-1/2" Spacer	438955¹	89.38
FLH, FXST, FLST, FXD, FXR	84-06	1-3/4" Spacer	438956¹	108.93

¹ exc. 2006 Dyna

BELT DRIVES LTD. CLUTCH HUB BIG FIX BEARING KIT

Solves many clutch problems, gives a firmer clutch basket and ends clutch slip. Replaces obsolete caged roller bearings.

- Includes 52 American made bearings, special grease, retainer and three clutch hub stud springs
- Made in USA



HARLEY-DAVIDSON	Year	P/N	Retail
FLH	36-84	439145	26.00
FX	71-84	439145	26.00



8mm



11mm



14mm

Belt pitch is a metric measurement from center to center of tooth

BELT DRIVES LTD. PRIMARY DRIVE REPLACEMENT BELTS

Premium quality durable belt.

Size	Teeth	BDL Fitment	PRIMO Fitment	Mfg/N	P/N	Retail
8 mm x 42 mm	130	68-48 Kevlar	P-48 68-1,3,5	BDL-130K	439080	93.10
8 mm x 41 mm	138	68-45 Kevlar		BDL-138K	439077	93.10
3 in.	141	72-47,EVO-9S		BDL-141-3	438997	100.55
3 in.	132	72-48,EVO11S		BDL-132-3	438996	100.55
8 mm 1-1/2 in.	132	61-41		BDL-30853 ST	438898	50.27
1-1/2 in. W	132		36-84 Big Twin	2024-0004	060424	84.95
8 mm 1-1/2 in.	132	61-41,62-39,62-40	2015-0013	BDL-30853-BE	670302	50.27
14 mm 3-3/8 in.	85	TF1000, TF2000		BDL-14-85	438904	213.20
8 mm 1-3/4 in.	138		Brute III 45-68 Kevlar	2024-0018	060378	131.95
2 in. W	144	76-47, 2T&2S	P-47-76 C&D, 2016-0214, 2016-0215	BDL-37144 2"	670314	71.69
3 in. W	144	76-47, 3T&3S	P-47-76 E&F, 2021-0018	BDL-37144-3	670316	100.55
1-3/4 in. W	130		Brute III	2024-0016	060446	119.95
13.8 mm 1-1/8 in.	78	Sturgis		PC-78-118	438871	102.41
11 mm 1-1/2 in.	99	47-31 (4-Speed)	P-31-47 (4-Speed)	BDL-1185	438896	55.86
14 mm 1-1/2 in.	78	37-24, 38-24 (4-Speed)	38078D	BDL-38078	670318	128.48
69 mm	142	EVO-8S		BDL-142-69	439140	114.51
2 in. W	142	EVO-8S-2,EVO-575,EVO-575-13		BDL-142-2	439208	111.95
2 in.	132	EVO-13B,EVO-11S		BDL-132B-KG	439202	109.00
1-1/2 in. W	101		Brute II Extreme	2024-0301	060442	202.95
1-3/4 in. W	101		Brute III	2024-0015	060395	262.95
11 mm 1-1/2 in.	96		37-84 Big Twin/Open or Closed/Kick or Electric, 29-44, 29-45 Pulley Combos	2024-0005	060592	158.92
14 mm 1-1/2 in.	78		65-84 Big Twin/Use with Idler Bearing Assy, 24-37 Pulley Combo	2024-0011	060598	197.49
	140			BDL-140-2	439125	105.95
8 mm	141			BDL-141-1-5/8	438833	60.50
11 mm	96			BDL-30884	438834	84.00
11 mm	92			BDL-5511	438835	78.50
8 mm, 3 in.	135			2021-0015	060166	97.50
8 mm, 2 in.	144		47-76 Pulley Combo	2021-0017	060167	128.95
8 mm, 2 in.	144		48-76 Pulley Combo	2021-0018	060168	120.95
11 mm, 1-1/2 in.	92			2024-0006	060169	111.95
8 mm, 1-1/2 in.	144			2024-0008	060170	110.95
11 mm, 1-1/2 in.	99		31-47 Pulley Combo	2024-0001	670301	67.95



RIVERA PRIMO ALTERNATOR COVER

Polished, cast aluminum cover protects the alternator on an open primary belt drive. Belt shroud mounting lug is a built-in feature.

- Made in USA



HARLEY-DAVIDSON	Year	P/N	Retail
FLH	70-98	060330	40.95
FXST	84-99	060330	40.95
FLST	86-99	060330	40.95
FXD	91-98	060330	40.95
FXR	82-94	060330	40.95
FX	71-86	060330	40.95



RIVERA PRIMO EQUALIZER MOTOR PLATE FOR OPEN BELT DRIVE

The Equalizer plate bolts to both Primo's alternator-cover and bearing-support to provide a strong structural link between the motor and transmission allowing open belt drive installations.

- Primo's Equalizer plate; no idler slot
- Polished finish
- Requirement for open belt drives installed on cone motors
- Made in USA



HARLEY-DAVIDSON	Year	P/N	Retail
Big Twin	70-84	060175 ¹	59.95

¹ 4-speed models



EXCLUSIVE

TWIN POWER PRIMARY-IN-A-BOX

A complete replica of the 94-97 Softail-style primary including a chrome inner and outer cover. It features a chrome inner and outer primary, inner and outer bolts and gaskets, and derby and inspection covers. It is complete with clutch shell and hub with discs and plates. The primary chain is not included (available separately).

HARLEY-DAVIDSON	Year	P/N	Retail
FXST, FLST	94-97	489884	1249.95



602207



410316

RIVERA PRIMO MAINSHAFT BEARING SUPPORT

Cast aluminum support furnished with bearing installed for open primary installations.

- Made in USA



Support

HARLEY-DAVIDSON	Year	P/N	Retail
Big Twin	65-E84	410316	36.50

Replacement Bearing

HARLEY-DAVIDSON	Year	P/N	Retail
Big Twin	70-84	602207 ¹	12.20

¹ 4-speed models



200617

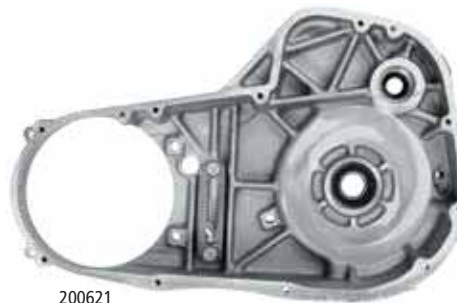

200621

DELKRON INNER PRIMARY CASES

Cast from A356-T6 high-grade aluminum for superior strength and CNC-machined for exact fit. These cases are thicker through the middle for added durability between the motor and transmission.

- Includes main bearing and seal, the starter shaft oil seal, the starter shaft bushing and the chain adjuster installed
- Made in USA



HARLEY-DAVIDSON	Year	P/N	Retail
FXST, FLST	94-06	200618	259.99
FXST, FLST	89-93	200617	259.99
FXR	94, 99	200623	338.90
FXR	89-93	200621	338.90

AUDIO, VIDEO
& NAVIGATION

INDIAN
& VICTORY

WINDSHIELDS

SEATS &
SISSY BARS

LUGGAGE

SECURITY
& COVERS

TIRES &
WHEELS

BRAKES

CHASSIS

SUSPENSION

SHEET METAL

EXHAUST

FUEL & AIR
SYSTEMS

ENGINE &
OIL FILTERS

PRIMARY DRIVE

TRANSMISSION
& FINAL DRIVE

GASKETS &
HARDWARE

HANDLEBARS
& CONTROL

CABLES

FOOT
CONTROL

INSTRUMENT
& LIGHTING

ELECTRICAL

BATTERIES &
CHARGERS

TRAILERS &
RAMPS

CHEMICALS
& LUBES

TOOLS &
SUPPLIES

GENERAL
ACCESSORIES
& DISPLAY

CROSS
REFERENCE

INDEX

PRIMARY DRIVE

PAUGHCO



598104



598103



598105

PAUGHCO INNER PRIMARY COVERS

Gloss black pieces for use as stock replacement covers or for custom applications. Custom inner cover replaces the aluminum inner on 65-69 Kickstart models only; the cover is approximately 3/16 in. deeper than P/N 598104 where it bolts to the case.

- Made in USA



HARLEY-DAVIDSON	Year	O.E.M.	P/N	Retail
Big Twin	65-69		598105²	132.95
Big Twin	55-64	60420-55B	598104¹	132.95
Big Twin	36-54	60620-36	598103¹	132.95

¹ 4-speed models

² custom inner cover models



603093



603193



EASTERN PRIMARY LOCK TABS

- Sold in packs of 10

HARLEY-DAVIDSON	Year	O.E.M.	P/N	Retail
Big Twin	87-05	33318-85	603093¹	12.50
Big Twin	80-86	7402	603193²	11.50

¹ inner cover

² 5-speed models with an inner cover



Primary
Gaskets

ON PAGE
1238

[EXCLUSIVE]

BIKER'S CHOICE® PRIMARY LOCK TABS

- Sold in packs of 10

HARLEY-DAVIDSON	Year	P/N	Retail
FLH	65-99	603210	4.50
FXST	84-99	603210	4.50
FLST	86-99	603210	4.50
FXD	91-99	603210	4.50
FXR	82-94	603210	4.50
FX	71-86	603210	4.50

BIKER'S CHOICE



488709



488707

[EXCLUSIVE]

BIKER'S CHOICE® INNER PRIMARY COVERS

O.E.M. Style

HARLEY-DAVIDSON	Year	Color	P/N	Retail
FXST, FLST	94-06	Chrome	488709	299.95
FXST, FLST	90-93	Chrome	488707	299.95

Offset Inner Primary Covers

- 1/2 in.

HARLEY-DAVIDSON	Year	P/N	Retail
FXST, FLST	90-93	489932	394.50

Colony
OEM and Custom
Hardware



044185



044332

COLONY INNER PRIMARY MOUNTING KITS

Includes hardware required to mount a stamped steel inner primary cover to the engine. May also be used when converting a 65-69 FL to a stamped-steel cover.

- Made in USA



HARLEY-DAVIDSON	Year	O.E.M.	P/N	Retail
FLT	01-16		044343	17.99
FLT, FXR	86-99		044333	16.99
FLH	80-85		044550	23.99
FLH	70-79		044549	27.99
FL, FLH	65-69		044358	23.99
EL, FL	37-54	60554-36	044185	20.99
EL, FL	55-64		044186	23.99
FXST, FLST	00-16		044343	17.99
FXST, FXD	94-99		044332	16.99
FXST, FLST	86-93		044331	16.99
FXD	99-16		044343	17.99
FXD	91-93		044331	16.99
FXD	80-85		044550	23.99
FX	80-85		044550	23.99
FX	71-79		044549	27.99

KURYAKYN

KURYAKYN® DELUXE INNER PRIMARY COVERS

Die-cast construction. Formed edges enhance the entire primary area. Four mounting points ensure secure, quiet operation.

HARLEY-DAVIDSON	Year	Mfg/N	P/N	Retail
FLH, FLT	09-16	7780	419540	139.99
FLTR	09-16	7780	419540	139.99
FLH, FLT	07-08	8397	493927	139.99
FLH, FLT	90-06	8294	497874²	119.99
FXST, FLST	00-06	8291	497871³	119.99
FXST, FLST	89-99	8299	497875^{1,4}	109.99
FXD	06-16	8377	493925⁵	139.99
FXD	06-16	8399	419375⁶	139.99
XL	04-16	7781	419369	109.99

¹ not compatible with rear suspension lowering kits

² O.E.M. crossover exhaust

³ works with lowered bikes

⁴ exc. 97-99 FLSTS

⁵ models with mid control

⁶ models with forward controls



493927



497874



497875



419369

KURYAKYN® INNER PRIMARY COVER EXTENSION

When using 2-1 or staggered performance exhaust with inner primary cover, this extension covers the area where the crossover pipe had been.

- For use with P/N 497874

Mfg/N	P/N	Retail
8295	496957	49.99



496957



KURYAKYN® INNER PRIMARY COVER

Works with the existing stock engine case and primary housing.

Note: Rear cover cannot be used on FLSTSC

HARLEY-DAVIDSON	Year	Mfg/N	P/N	Retail
FXST, FLST	07-16	8398	496861	139.99

KURYAKYN® INNER PRIMARY COVER FRONT EXTENSION

Covers the shift pivot area and grease fitting.

HARLEY-DAVIDSON	Year	Mfg/N	P/N	Retail
FLH	90-06	8370	496958	39.99



EXCLUSIVE

BIKER'S CHOICE® INNER PRIMARY BOLT RETAINER

- Sold individually

HARLEY-DAVIDSON	Year	P/N	Retail
FLH	70-84	488713	3.95
FX	71-84	488713	3.95



EASTERN GEAR CASE DOWEL PINS

- 0.308 x 0.690 long
- Sold in packs of 25

HARLEY-DAVIDSON	Year	P/N	Retail
XL	54-90	602998	19.95



PAUGHCO

PAUGHCO INNER BOLT RETAINER

Easier to install than safety wire for a more positive lock, in less time.

- Made from 20-gauge steel with zinc plate
- Made in USA
- Sold individually



HARLEY-DAVIDSON	Year	P/N	Retail
FLH	70-84	602080	7.95
FX	71-84	602080	7.95



AUDIO, VIDEO & NAVIGATION

INDIAN & VICTORY

WINDSHIELDS

SEATS & SISSY BARS

LUGGAGE

SECURITY & COVERS

TIRES & WHEELS

BRAKES

CHASSIS

SUSPENSION

SHEET METAL

EXHAUST

FUEL & AIR SYSTEMS

ENGINE & OIL FILTERS

PRIMARY DRIVE

TRANSMISSION & FINAL DRIVE

GASKETS & HARDWARE

HANDLEBARS & CONTROL

CABLES

FOOT CONTROL

INSTRUMENT & LIGHTING

ELECTRICAL

BATTERIES & CHARGERS

TRAILERS & RAMPS

CHEMICALS & LUBES

TOOLS & SUPPLIES

GENERAL ACCESSORIES & DISPLAY

CROSS REFERENCE

INDEX

PRIMARY DRIVE

ARLEN NESS



ARLEN NESS 10-GAUGE PRIMARY COVERS

- CNC-machined from billet aluminum
- Available in chrome or black anodized finish

Harley-Davidson	Year	Finish	P/N	Retail
FLH	99-16	Chrome	263671	799.95
FLH	99-16	Black	263672	799.95
FXST, FLST	00-16	Chrome	263671	799.95
FXST, FLST	00-16	Black	263672	799.95
FXD	99-16	Chrome	263671	799.95
FXD	99-16	Black	263672	799.95

PAUGHCO



Primary Gaskets ON PAGE 1238

PAUGHCO OUTER PRIMARY COVERS

Use in stock replacement applications on Big Twin models.

- Made in USA

HARLEY-DAVIDSON	Year	P/N	Retail
FL, FLH	55-64	598107¹	169.95
FL, FLH	36-54	598124²	169.95
FL	36-54	598107³	169.95
FL	36-54	598106⁴	18.95

- ¹ 4-speed models with compensating sprockets
² 4-speed models without compensating sprockets
³ Fits models if P/N 598103 inner primary is used
⁴ Inspection cover for Big Twin models



COLONY INNER PRIMARY COVER REAR BOLT KIT

- Chrome
- Replaces O.E.M. 3814-36

HARLEY-DAVIDSON	Year	P/N	Retail
Big Twin	36-64	043886	12.99



BIKER'S CHOICE



EXCLUSIVE

BIKER'S CHOICE® PRIMARY COVERS

Covers are of die-cast construction, reinforced at critical areas. FL covers feature a floorboard mounting tab.

- Available in chrome or black finishes
- Bearing not included

HARLEY-DAVIDSON	Year	O.E.M.	Finish	P/N	Retail
FLH	99-06	60665-99	Chrome	489672	280.95
FL	65-84	60508-70	Chrome	490800²	199.95
FX	71-84	60507-77	Chrome	490801²	189.95
FXST, FLST	07-16	60782-06	Chrome	488708	296.95
FXD	06-16	60764-06	Chrome	488710^{3,5}	296.95
FXDWG	06-07	60782-06	Chrome	488708	296.95
FXST, FLST, FXD	00-06	60543-99	Chrome	493226⁴	329.95
FXST, FLST, FXD	95-99	60543-95	Chrome	489882¹	250.95
FXST, FLST, FXD	89-93	60543-89	Chrome	489626	249.95
XL	06-16	25460-06	Chrome	489671	322.95
XL	06-16		Black	482889	237.95

- ¹ Will fit 02-05 models with early derby cover
² #603199 bearing sold separately
³ Models with Mid Controls

- ⁴ exc. 2006 Dyna
⁵ exc. 06-07 FXDWG



COLONY OUTER PRIMARY MOUNTING KITS

- O.E.M. style
- Chrome-plated
- Made in USA



HARLEY-DAVIDSON	Year	Type	P/N	Retail
FLH	07-16	Allen Polished	043931	44.99
FLH	99-16	Allen Chrome	044459	26.99
FLH	99-16	Allen Polished	044460	32.99
FLH, FXR	85-99	Allen Chrome	044386	27.99
FLH, FXST, FLST, FXR, FX	70-86	Acorn	044135	46.99
FLH, FXR	80-84	Allen Chrome	044089	25.99
FLH, FX	70-80	Slotted Chrome	044453	20.99
FLH, FX	65-79	Cap Style	044060	22.99
FL	65-69	Slotted Chrome	044288	24.99
FL	65-69	Slotted CAD	044359	20.99
FL, EL	36-69	Allen Chrome	044086	19.99
FL, EL	36-69	Cap Style	044061	56.99
FL, EL	36-64	Slotted Chrome	044229	21.99
FL, EL	36-64	Slotted CAD	043987	15.99
FL, EL	36-64	Slotted Parkerized	044454	15.99
FL, EL	36-64	Acorn	044145	58.99
FXST, FLST	07-16	Allen Polished	043934	39.99
FXST, FLST	89-06	Allen Chrome	044387	36.99
FXST, FLST	89-06	Acorn	044387	36.99
FXD	06-16	Allen Chrome	043929	28.99
FXD	91-05	Allen Chrome	044387	36.99
XL	04-16	Allen Chrome	043914	34.99
XL	94-03	Allen Chrome	044458	23.99
XL	91-93	Allen Chrome	044457	21.99
XL	86-90	Allen Chrome	044455	18.99
XL	77-85	Allen Chrome	044334	16.99
XL	71-76	Allen Chrome	044177	16.99
XL	57-69	Allen Chrome	044456	9.99



GARDNER-WESTCOTT CAM AND PRIMARY COVER SETS

- Sportster kits include cam and primary with inspection, sprocket and oil fill check screws where applicable
- Big Twin kits include cam, primary, transmission, chain clutch or derby where applicable.
- Chrome-plated allen
- Made in USA



Polished

HARLEY-DAVIDSON	Year	P/N	Retail
Softail	07-12	041756	97.95
FLT	07-11	041758	90.95
FLT	99-06	040986	84.95
Dyna	07-11	041757	88.95
Dyna	99-05	040984	92.95

Knurled

HARLEY-DAVIDSON	Year	P/N	Retail
Softail	00-06	041863	71.95
Softail	87-99	041538	67.95
FLT	07-11	041546	81.95
FXR, FLT	87-98	041530	54.95
FLH, FX	70-86	041540	22.95
Dyna	06-11	041545	74.95
XL	04-11	041548	63.95
XL	91-03	041739	51.95



GARDNER-WESTCOTT PRIMARY COVER ONLY CUSTOM HARDWARE KITS FOR V-TWIN

- Chrome-plated Allen
- Made in USA



HARLEY-DAVIDSON	Year	P/N	Retail
FLT	07-16	041462	42.95
FLT	99-06	041873	27.95
FLT, FXR	85-98	041533	22.95
Big Twin	70-86	041542 ¹	18.95
FXST, FLST	07-16	041461	40.95
FXST, FLST	00-06	041872	37.95
FXST, FLST	89-99	041685	32.95
FXST, FLST	86-88	041539	27.95
FXD	06-16	041461	40.95
FXD	99-05	041872	37.95
FXD	91-98	041685	32.95
XL	04-16	041464	40.95
XL	91-03	041463	28.95

¹ 4-speed models



488140

NEW!

FEULING® PRIMARY AND TRANSMISSION 12 POINT BOLT KIT

Kits include 12-point stainless bolts and applicable washers for the primary cover, derby cover, inspection cover, transmission top cover, transmission bearing housing, clutch release cover, speed sensor and engine to transmission mounting bolts.

HARLEY-DAVIDSON	Year	P/N	Retail
FLH	07-16	488143	219.95
FLH	00-06	488142	219.95
FXST, FLST	07-16	488145	219.95
FXST, FLST	00-06	488144	219.95
FXD	06-16	488141	199.95
FXD	99-05	488140	199.95
XL	04-16	488147	122.50

PRIMARY DRIVE



S&S® MAGNETIC DRAIN PLUGS

- Made in USA



P/N	Retail
491248	5.95



EXCLUSIVE

BIKER'S CHOICE® MAGNETIC AND NON-MAGNETIC DRAIN PLUGS

- Made in USA



Type	Size	O.E.M.	P/N	Retail
Magnetic Hex Style	1/2 in.	56381-96, 60348-65B	491246	6.06
Magnetic Hex Style	5/8 in.	722, 71546-75A	491244	21.95
Magnetic Hex Style	1/2 in.	707, 68008-73A	491243	4.15
Non-Magnetic Drain Plug	3/8 in.	700, 67215-89	491245	6.06



491246



EXCLUSIVE

BIKER'S CHOICE® MAINSHAFT SUPPORT BEARINGS

- Made in USA

Note: P/N 602204 will work for 85-up belt drives needing sealed bearings



HARLEY-DAVIDSON	Year	O.E.M.	P/N	Retail
Big Twin	85-06	9135	410177	21.34
FLT, FXR	80-E84	8975	602204	5.95
Big Twin	70-84	9061	602207 ¹	12.20

¹ 4-speed models



RIVERA PRIMO INNER PRIMARY BEARINGS

When converting a primary drive to dry clutch (Primo Brute III) the O.E.M. two-piece bearing must be lubricated and sealed (using the grease and seal provided in the Brute III kit). Optionally it can be replaced with Primo's sealed bearing, which is pressed into the primary case. The O.E.M. race is removed from the transmission main shaft allowing the primary to be installed over the transmission main shaft (the replacement bearing is a slip-fit on the main shaft). No honing required.

P/N	Retail
060154	18.95



COLONY PRIMARY COVER PLUGS

Primary plugs for Sportsters include required O-ring seal and are easily installed with a 15/16 in. wrench.

- Made in USA



044283

HARLEY-DAVIDSON	Year	Finish	P/N	Retail
XL	86-90	Chrome	044283	34.99
XL	77-85	Chrome	044184	34.99
XL	54-70	Aluminum	043905	19.99



489875



489874



489877



489876

EXCLUSIVE

TWIN POWER STARTER BUSHINGS

Inner Primary Starter Bushing

HARLEY-DAVIDSON	Year	O.E.M.	P/N	Retail
Big Twin	94-06	33445-94A	489875 ¹	8.95
Big Twin	89-93	33445-89	489874	9.95

Outer Primary Starter Bushing

HARLEY-DAVIDSON	Year	O.E.M.	P/N	Retail
Big Twin	94-06	33446-94A	489877 ¹	6.95
Big Twin	89-93	33446-89	489876	7.50

¹ exc. 2006 Dyna



JIMS® PRIMARY BEARING UPGRADE

Perfect for an open primary system or for added durability in a highoutput system.

- Kit includes double row ball bearing with seal and retaining ring
- Made in USA



HARLEY-DAVIDSON	Year	P/N	Retail
FLH	90-06	461033	35.20
FXST, FLST	90-06	461033	35.20
FXD	91-05	461033	35.20
FXR	90-94	461033	35.20

**BAKER™ HIGH TORQUE BEARING KIT**

Mfg/N 34091-85 Inner bearing race has been used on Big Twins since 1985. The inner primary bearing rides on this race. By design, this race press-fits onto the transmission mainshaft; this system works fine for stock engines. 100 HP+ engines will make this race walk on the mainshaft; if it walks inboard, it will damage the maindrive gear seal and cause a transmission oil leak; if it walks outboard, it will cause a primary oil leak; the high torque bearing kit eliminates this condition.

- Kit includes a precision honed bearing and seal
- Made in USA



HARLEY-DAVIDSON	Year	P/N	Retail
FLH	85-07	410850	41.49
FXST	85-07	410850	41.49
FLST	86-07	410850	41.49
FXD	91-07	410850	41.49
FXR	85-94	410850	41.49

High Torque Bearing Kit Replacement Seal

P/N	Retail
410692	8.99

**ALL BALLS RACING INNER PRIMARY BEARING KIT**

- Includes one seal, one needle bearing and one needle bearing shaft

HARLEY-DAVIDSON	Year	P/N	Retail
FLH	08-16	497983	38.99
FXST, FLST	08-16	497983	38.99
FXD	08-16	497983	38.99

**ALL BALLS RACING INNER PRIMARY BEARING UPGRADE**

For High-Performance engines and bikes converted to open primary belt drive.

- Includes one 25.025 bore double row angular contact bearing, one snap ring and one inner primary seal

HARLEY-DAVIDSON	Year	P/N	Retail
FLH	90-06	497977	19.99
FXST, FLST	90-06	497977	19.99
FXD	91-05	497977	19.99
FXR	90-94	497977	19.99



Roland Sands Design
MOTORCYCLES ♦ PARTS ♦ LEATHERS



Chrome



Contrast Cut



Gloss Black



Machine Ops

ROLAND SANDS DESIGN® NOSTALGIA DERBY COVERS

Designed as a direct replacement for your stock derby cover on your O.E.M. primary. Laser-engraved RSD Logo. Covers are hand sanded for a unique handcrafted look.

- Hardware included
- Black Ops, RSD's newest finish option is gloss black with a contrasting textured black; go covert with RSD Black Ops
- Will not fit 2016 FLH/T or 2015 FLH Low
- Made in USA



HARLEY-DAVIDSON	Year	Chrome	Retail	Contrast Cut	Retail	Gloss Black	Retail	Black Ops	Retail	Machine Ops	Retail	Polished	Retail
FLH, FLT, FXST, FLST, FXD	99-16	RD3174	149.95	RD3173	159.95	RD3172	149.95	RD3176	149.95	RD3177	159.95	RD3175	129.95
XL	04-16	RD3181	159.95	RD3180	159.95	RD3179	159.95	RD3182	159.95	RD3178	159.95		

AUDIO, VIDEO & NAVIGATION

INDIAN & VICTORY

WINDSHIELDS

SEATS & SISSY BARS

LUGGAGE

SECURITY & COVERS

TIRES & WHEELS

BRAKES

CHASSIS

SUSPENSION

SHEET METAL

EXHAUST

FUEL & AIR SYSTEMS

ENGINE & OIL FILTERS

PRIMARY DRIVE

TRANSMISSION & FINAL DRIVE

GASKETS & HARDWARE

HANDLEBARS & CONTROL

CABLES

FOOT CONTROL

INSTRUMENT & LIGHTING

ELECTRICAL

BATTERIES & CHARGERS

TRAILERS & RAMPS

CHEMICALS & LUBES

TOOLS & SUPPLIES

GENERAL ACCESSORIES & DISPLAY

CROSS REFERENCE

INDEX

PRIMARY DRIVE



Roland Sands Design
MOTORCYCLES ♦ PARTS ♦ LEATHERS



Chrome RD3236



Contrast Cut RD3235



Black Ops RD3237



Machine Ops RD3238



Chrome RD3250



Contrast Cut RD3249



Black Ops RD3251

ROLAND SANDS DESIGN® CLARITY DERBY COVERS

The RSD Clarity Derby Cover is the next best thing to an open primary. Articulately-machined billet aluminum frames transparent polycarbonate, giving you the same feel of a spinning clutch pack, yet is fully enclosed. Now you can show off that trick clutch. Allows for viewing of internal engine components. Specialty coating does not allow oil and grease to adhere and a proprietary abrasion- and UV-resistant film to protect surface from yellowing, marring or breakage. RSD Contrast Cut product starts with a finely-machined polished and black anodized part which is re-machined to bring out the design highlights; close attention is paid to machine pattern and quality to ensure the best and cleanest machine work.

- Direct replacement for your stock derby cover on your O.E.M. primary
- CNC-machined from billet aluminum and polycarbonate
- Machined RSD Logo
- All mounting hardware included
- Matching Clarity Air Cleaner and Timing/Cam Cover available
- Black Ops, RSD's newest finish option is gloss black on top of a contrasting textured black
- Will not fit 2016 FLH/T or 2015 FLH Low
- Made in USA



RD3602



HARLEY-DAVIDSON	Year	Chrome	Retail	Contrast Cut	Retail	Black Ops	Retail	Machine Ops	Retail	Gasket	Retail
FLH	99-15	RD3236	239.95	RD3235	229.95	RD3237	229.95	RD3238	229.95	RD3602	7.50
FXST, FLST	00-16	RD3236	239.95	RD3235	229.95	RD3237	229.95	RD3238	229.95	RD3602	7.50
FXD	99-16	RD3236	239.95	RD3235	229.95	RD3237	229.95	RD3238	229.95	RD3602	7.50
XL	04-16	RD3250	219.95	RD3249	219.95	RD3251	219.95	RD3252	219.95	RD3602	7.50
FLH	70-98	RD3600	239.95								
FXST	84-99	RD3600	239.95								
FLST	86-99	RD3600	239.95								
FXD	91-98	RD3600	239.95								
FXR	82-94	RD3600	239.95								
FX	71-86	RD3600	239.95								



Chrome



Gloss Black



Contrast Cut

ROLAND SANDS DESIGN® NOSTALGIA INSPECTION COVERS

Designed as a direct replacement for your chain tension inspection cover on your O.E.M. primary. Laser-engraved RSD Logo.

- Chrome hardware included
- Gaskets included
- Made in USA



HARLEY-DAVIDSON	Year	Finish	P/N	Retail
FXDWG	93-05	Chrome	RD3195	99.95
FXDWG	93-05	Gloss Black	RD3193	99.95
FXDWG	93-05	Contrast Cut	RD3194	109.95
FXDWG	93-05	Polished	RD3196	89.95
FX/FL, FXST/FLST, FXWG	70-06	Chrome	RD3195	99.95
FX/FL, FXST/FLST, FXWG	70-06	Gloss Black	RD3193	99.95
FX/FL, FXST/FLST, FXWG	70-06	Contrast Cut	RD3194	109.95



Formula



Contrast Cut



Chrome

Drive



Contrast Cut



Black Ops



Chrome

Scallop



Contrast Cut



Black Ops



Chrome

PERFORMANCE MACHINE INSPECTION COVERS

Drive Covers:

The Drive Cover Line's hot rod styling is a quintessential part of PM's cool blood. The Drive's composition are speed lines that start and finish fast with a modest bevel to the corners. Simple yet aggressive, bold yet elegant.

Formula Covers:

The Formula design was born from the concept of a contemporary, simplistic composition that pays homage to the early lightweight spoke race wheels. Performance Machine adopted those sexy cues from the Formula wheel and engineered a set of engine and drivetrain covers to match. These CNC-machined covers feature streamlined spokes stemming from the center for an unforgettable impression. Like our other cover lines, these ship to you with gaskets and hardware for a nice D.I.Y. install.

The Formula cover line includes a cover for the Rocker Box, Cam/Timing, Derby, Inspection, Transmission, Clutch and are available in Show Chrome™ and our famous Contrast Cut™ finishes. All covers are a direct replacement for O.E. covers that are shipped with hardware and all necessary gaskets.

Scallop Covers:

The PM Scallop Cover Line will put the devil in the details from front to rear and top to bottom with every cover possible. Each Scallop cover features timeless styled machined cut scallops with the iconic PM logo.



HARLEY-DAVIDSON	Year	Finish	Formula	Retail	Drive	Retail	Scallop	Retail
FLH, FXST, FLST, FXWG	84-06	Chrome			PM3263	99.95	PM3233	99.95
FLH, FXST, FLST, FXWG	84-06	Black Ops			PM3264	99.95	PM3234	99.95
FLH, FXST, FLST, FXWG	84-06	Contrast Cut			PM3261	99.95	PM3231	99.95
FLH, FXST, FLST, FXWG	84-06	Platinum Cut			PM3262	99.95	PM3232	99.95
FXDWG	93-05	Chrome			PM3263	99.95	PM3233	99.95
FXDWG	93-05	Black Ops			PM3264	99.95	PM3234	99.95
FXDWG	93-05	Contrast Cut			PM3261	99.95	PM3231	99.95
FXDWG	93-05	Platinum Cut			PM3262	99.95	PM3232	99.95
FXST, FLST	84-06	Chrome	PM3681	99.95				
FXST, FLST	84-06	Contrast Cut	PM3680	99.95				
FXDWG	93-05	Chrome	PM3681	99.95				
FXDWG	93-05	Contrast Cut	PM3680	99.95				

PRIMARY DRIVE



Formula



Contrast Cut



Chrome

Drive



Contrast Cut



Platinum Cut



Chrome



Black Ops

Scallop



Contrast Cut



Platinum Cut



Chrome



Black Ops

PERFORMANCE MACHINE DERBY COVERS

Drive Covers:

The Drive Cover Line's hot rod styling is a quintessential part of PM's cool blood. The Drive's composition are speed lines that start and finish fast with a modest bevel to the corners. Simple yet aggressive, bold yet elegant.

Formula Covers:

The Formula design was born from the concept of a contemporary, simplistic composition that pays homage to the early lightweight spoke race wheels. Performance Machine adopted those sexy cues from the Formula wheel and engineered a set of engine and drivetrain covers to match. These CNC-machined covers feature streamlined spokes stemming from the center for an unforgettable impression. Like our other cover lines, these ship to you with gaskets and hardware for a nice D.I.Y. install.

The Formula cover line includes a cover for the Rocker Box, Cam/Timing, Derby, Inspection, Transmission, Clutch and are available in Show Chrome™ and our famous Contrast Cut™ finishes. All covers are a direct replacement for O.E. covers that are shipped with hardware and all necessary gaskets.

Scallop Covers:

The PM Scallop Cover Line will put the devil in the details from front to rear and top to bottom with every cover possible. Each Scallop cover features timeless styled machined cut scallops with the iconic PM logo.

- Will not fit 2016 FLH/T or 2015 FLH Low



HARLEY-DAVIDSON	Year	Finish	Formula	Retail	Drive	Retail	Scallop	Retail
Twin Cam	99-16	Contrast Cut			PM3257 ¹	149.95		
Twin Cam	99-16	Platinum Cut			PM3258 ¹	149.95		
Twin Cam	99-16	Chrome			PM3259 ¹	149.95		
Twin Cam	99-16	Black Ops			PM3260 ¹	149.95		
FLH	99-16	Chrome	PM3679	149.95				
FXST, FLST	00-16	Chrome	PM3679	149.95				
FXD	99-16	Chrome	PM3679	149.95				
FLH	99-16	Contrast Cut	PM3678	149.95				
FXST, FLST	00-16	Contrast Cut	PM3678	149.95				
FXD	99-16	Contrast Cut	PM3678	149.95				
Twin Cam	99-16	Chrome					PM3225 ¹	149.95
Twin Cam	99-16	Black Ops					PM3226 ¹	149.95
Twin Cam	99-16	Contrast Cut					PM3223 ¹	149.95
Twin Cam	99-16	Platinum Cut					PM3224 ¹	149.95
Big Twin	70-99	Chrome					PM3229 ²	149.95
Big Twin	70-99	Black Ops					PM3230 ²	149.95
Big Twin	70-99	Contrast Cut					PM3227 ²	149.95
Big Twin	70-99	Platinum Cut					PM3228 ²	149.95

¹ 5 holes

² 3 holes

BARNETT CLEAR DERBY COVERS

A quarter inch thick, clear polycarbonate window to your clutch! The outer cover is CNC-machined from billet aluminum, chrome plated and then the scratch and discoloration resistant window is firmly secured in place and sealed with an O-ring gasket.

- The derby cover gasket is also included
- Chrome-plated



HARLEY-DAVIDSON	Year	Finish	P/N	Retail
Big Twin	07-16	Chrome	497681	239.95
Big Twin	07-16	Black	497691	239.95
Big Twin	99-06	Chrome	497671	239.95
Big Twin	99-06	Black	497683	239.95



Barnett
Clutches
& Cables

ARLEN NESS

Deep Cut



Chrome

Black

Deep Cut II



Chrome

Black

Slot Track



Chrome

Black

Beveled



Chrome

Black

Engraved



Chrome

Black

Retro



Chrome

10-Gauge



Chrome

Black

ARLEN NESS DERBY COVERS

CNC-machined from billet aluminum. Each style has matching point covers and many other accessories available.

- Available in chrome or black anodized finish
- Each cover includes chrome hardware

HARLEY-DAVIDSON	Year	Style	Chrome	Retail	Black	Retail
FLH, FLT	2016	Deep Cut			263700	149.95
FLH, FLT	2016	Deep Cut II	263765	149.95	263764	149.95
FLH, FLT	2016	Slot Track			263701	149.95
FLH, FLT	2016	Beveled	263703	149.95	263699	149.95
FLH, FLT	2016	10-Gauge			263698	149.95
FLH, FLT, FXST, FLST, FXD	99-16	Deep Cut	262390¹	151.50	262389¹	149.95
FLH, FLT, FXST, FLST, FXD	99-16	Deep Cut II	263763¹	149.95	263762¹	149.95
FLH, FLT, FXST, FLST, FXD	99-16	Slot Track	262386¹	149.95	262385¹	149.95
FLH, FLT, FXST, FLST, FXD	99-16	Beveled	260943¹	149.95	260942¹	149.95
FLH, FLT, FXST, FLST, FXD	99-16	Retro	260824¹	149.95		
FLH, FLT, FXST, FLST, FXD	99-16	Engraved	260828¹	149.95	260826¹	149.95
FLH, FLT, FXST, FLST, FXD	99-16	10-Gauge	263705¹	149.95	263704¹	149.95
XL	04-16	Beveled	260944	149.95	260945	149.95

¹ exc. 16 FLH, FLT

PRIMARY DRIVE

AUDIO, VIDEO
& NAVIGATION

INDIAN
& VICTORY

WINDSHIELDS

SEATS &
SISSY BARS

LUGGAGE

SECURITY
& COVERS

TIRES &
WHEELS

BRAKES

CHASSIS

SUSPENSION

SHEET METAL

EXHAUST

FUEL & AIR
SYSTEMS

ENGINE &
OIL FILTERS

PRIMARY DRIVE

TRANSMISSION
& FINAL DRIVE

GASKETS &
HARDWARE

HANDLEBARS
& CONTROL

CABLES

FOOT
CONTROL

INSTRUMENT
& LIGHTING

ELECTRICAL

BATTERIES &
CHARGERS

TRAILERS
& RAMPS

CHEMICALS
& LUBES

TOOLS &
SUPPLIES

GENERAL
ACCESSORIES
& DISPLAY

CROSS
REFERENCE

INDEX



NEW! EXCLUSIVE

SAN DIEGO CUSTOMS DERBY COVERS

CNC-machined five-hole derby cover. Fits 00 and up Twin Cam five-hole bolt pattern. Made in San Diego.



HARLEY-DAVIDSON	Year	Style	P/N	Retail
Twin Cam	99-16	Ripper	482245	139.00
Twin Cam	99-16	Chrome Shield	482249	150.00
Twin Cam	99-16	Black Shield	482250	139.00
Twin Cam	99-16	GFY	482246	139.00
Twin Cam	99-16	Chrome Number 1	482248	139.00
Twin Cam	99-16	Black Number 1	482247	150.00
Evolution	84-99	Ripper	482251	139.00
Evolution	84-99	Chrome Shield	482255	150.00
Evolution	84-99	Black Shield	482256	139.00
Evolution	84-99	GFY	482252	139.00
Evolution	84-99	Chrome Number 1	482253	150.00
Evolution	84-99	Black Number 1	482254	139.00



482251



482252



482253



482254



482256



482255



JACK DANIEL'S® OLD NO. 7 DERBY COVERS

Aluminum derby covers reflect the quality and style that come with the Jack Daniel's® name. A great complement to the other matching accessories available from the Jack Daniel's® motorcycle parts line.

- Available in chrome, chrome with a black insert and black wrinkle finish
- Die-cast construction with a beautiful finish

HARLEY-DAVIDSON	Year	Finish	P/N	Retail
Twin Cam	99-16	Chrome/Black	077700	89.99
Twin Cam	99-16	Black/Machined	077701	89.99
Twin Cam	99-16	Chrome	077702	89.99



Chrome/Black



Black/Machined



Chrome

BAHN

BAHN™ TIMING AND DERBY COVERS

The Bahn™ Derby Cover is engineered from premium forged aluminum, precision machined with unique designs to complement the rest of the Bahn™ product line. Direct replacement for the five-hole O.E.M. derby cover and reuses stock mounting hardware.

HARLEY-DAVIDSON	Year	Finish	P/N	Retail
Twin Cam	99-16	Chrome	505461	149.99
Twin Cam	99-16	Tuxedo	505460	149.99



Tuxedo



Chrome

KURYAKYN

NEW!

KURYAKYN® MESH DERBY COVERS

Heavy-duty bolt-on replacement for Twin Cam derby covers. Unique three-piece design features an aluminum outer frame and baseplate, with a formed steel insert secured with included hardware upon installation. Individual components can be custom-painted to match any color theme.

HARLEY-DAVIDSON	Year	Finish	Mfg/N	P/N	Retail
FLH, FLT	2016	Chrome	6526	488192	99.99
FLH, FLT	2016	Black	6527	488193	99.99
FLH, FLT	99-15	Chrome	6524	488190	99.99
FLH, FLT	99-15	Black	6525	488191	99.99
FXST, FLST, FXD	99-16	Chrome	6524	488190	99.99
FXST, FLST, FXD	99-16	Black	6525	488191	99.99
XL	04-16	Chrome	6528	488194	99.99
XL	04-16	Black	6529	488195	99.99



Chrome



Black



060582



060584

RIVIERA PRIMO BILLET VENTED DERBY AND INSPECTION COVERS

Show chrome billet-aluminum inspection cover. Recommended for enclosed belt drives. Used to keep the enclosed primary cool to prevent belt wear.

- Made in USA



HARLEY-DAVIDSON	Year	Type	P/N	Retail
FLH	70-98	Derby	060584	69.24
FLH	65-84	Inspection	060582	49.57
FXST	84-98	Derby	060584	69.24
FXST	84-06	Inspection	060582	49.57
FLST	86-98	Derby	060584	69.24
FLST	86-06	Inspection	060582	49.57
FXD	91-98	Derby	060584	69.24
FXD	91-05	Inspection	060582	49.57
FXR	82-94	Derby	060584	69.24
FX	71-86	Derby	060584	69.24
FX	71-86	Inspection	060582	49.57

RIVIERA PRIMO BRUTE IV ALTERNATOR COVER

Covers that unsightly alternator rotor. Adds that finishing touch.

- Made in USA
- For Primo Brute IV and all open primary belt drives



P/N	Retail
060595	37.50



RIVIERA PRIMO VENTED INSPECTION COVER

Matching, brushed aluminum. Louvered covers provide needed ventilation for closed primary belt drives.

- Made in USA



HARLEY-DAVIDSON	Year	P/N	Retail
FLH	65-84	060356	13.95
FXST	84-06	060356	13.95
FLST	86-06	060356	13.95
FXD	91-05	060356	13.95
FX	71-86	060356	13.95



216664



216663

NEW! EXCLUSIVE

TWIN POWER™ INSPECTION COVERS FOR FXR

- High-quality billet aluminum replacement for the factory cast cover
- Available in natural billet or chrome finish
- Includes stainless steel washers
- Made in USA



HARLEY-DAVIDSON	Year	Finish	P/N	Retail
FXR	184-94	Chrome	216664	59.00
FXR	184-94	Natural	216663	38.00



492435



598108

EXCLUSIVE

BIKER'S CHOICE® EARLY DERBY COVER

- Made in USA



HARLEY-DAVIDSON	Year	Finish	P/N	Retail
EL, FL	36-64	Chrome	492435	38.95
EL, FL	36-64	Black	598108	38.95

PRIMARY DRIVE



EXCLUSIVE

BIKER'S CHOICE® LATE INSPECTION COVERS

- Chrome-plated
- H-D®#60572-78T

HARLEY-DAVIDSON	Year	P/N	Retail
FLH	65-84	490592	14.95
FXST	84-06	490592	14.95
FLST	86-06	490592	14.95
FXD	91-05	490592	14.95
FX	71-86	490592	14.95



492996



492995

EXCLUSIVE

BIKER'S CHOICE® PRIMARY INSPECTION COVERS

- Chrome-plated

HARLEY-DAVIDSON	Year	Type	O.E.M.	P/N	Retail
XL	91-93	Clutch	34742-90	492996	10.50
XL	91-93	Chain	34745-90	492995	9.45



611043



620856

NEW!

PRO-ONE™ BALL-MILLED DERBY AND INSPECTION COVERS

These billet covers are CNC-machined from solid billet aluminum, carefully polished, then show-chrome plated to perfection.

- Chrome hardware included

HARLEY-DAVIDSON	Year	Type	P/N	Retail
FLH	70-98	Derby Cover	620856	99.95
FXST	84-99	Derby Cover	620856	99.95
FXST	84-06	Inspection Cover	611043	51.95
FLST	86-99	Derby Cover	620856	99.95
FLST	86-06	Inspection Cover	611043	51.95
FXD	91-98	Derby Cover	620856	99.95
FXD	93-05	Inspection Cover	611043	51.95
FXR	82-94	Derby Cover	620856	99.95
FX	71-86	Derby Cover	620856	99.95
FX	84-86	Inspection Cover	611043	51.95



490547



666744



666742



490260

EXCLUSIVE

BIKER'S CHOICE® DERBY COVERS

HARLEY-DAVIDSON	Year	Finish	P/N	Retail
Big Twin	99-16	Chrome	490547	31.95
Big Twin	99-16	Black Finned	666742	34.95
Big Twin	99-16	Chrome With Skull	666744	39.95
Big Twin	99-16	Grooved Chrome	490829	37.95
Big Twin	99-16	Grooved Black	490832	37.95
Big Twin	70-99	Chrome	490260	19.95
Big Twin	70-99	Grooved Chrome	490826	33.95
Big Twin	70-99	Grooved Black	490828	33.95
XL	04-16	Chrome	493061	32.95
XL	04-16	Black	482890	33.95
XL	94-03	Chrome	490265	30.95



482645



482888

EXCLUSIVE

BIKER'S CHOICE® INSPECTION COVER

- Hardware included
- H-D®#34761-04

HARLEY-DAVIDSON	Year	Finish	O.E.M.	P/N	Retail
XL	04-16	Chrome	34761-04	482645	37.95
XL	04-16	Black	34761-04	482888	25.95

PAUGHCO



PAUGHCO INSPECTION COVER

- Use in stock replacement applications on 45 in. and Big Twin models

HARLEY-DAVIDSON	Year	P/N	Retail
FL, WL	36-64	598106	18.95

GARDNER-WESTCOTT INSPECTION AND DERBY COVER CUSTOM HARDWARE

- Tapered Allen
- Made in USA



HARLEY-DAVIDSON	Year	P/N	Retail
FL	36-64	041557	17.95



**EXCLUSIVE****TWIN POWER PRIMARY CHAIN**

These high-quality replacement primary chains from Twin Power are superior to the O.E.M. parts. Our premium quality endless chains offer you precision-ground side plates for smoother operation. Their specifications and performance are designed to be superior to O.E. chains.

- Made in Japan

HARLEY-DAVIDSON	Year	O.E.M.	P/N	Retail
FLH, FLT	07-16	40037-07	591204¹	79.00
Softail	07-16	40036-06	591205	79.00
Dyna	06-16	40036-06	591205	79.00
Sportster	04-16	40147-04	591203⁵	72.95
FLT, FXR	80-06	40037-79A	591200²	71.75
XL, XR	57-16	40005-57A	591202³	71.95
Big Twin, Dyna, Softail	36-06	40007-36B	591201⁴	76.00

¹ 87 links² 76 links³ 94 links, exc. 04-13 model Sportster, 1200cc XR models⁴ 82 links, 4-Speed models,

exc. 04-13 Softail models

⁵ 1200 models**NEW! EXCLUSIVE****TWIN POWER™ TENSION RELIEVER
MANUAL PRIMARY CHAIN ADJUSTER**

An overtightened primary chain is known to cause premature failure of the engine, transmission and primary bearings as well as other complications. Usually, the factory automatic primary chain tensioner is the culprit. The Twin Power Tension Reliever helps prevent premature engine and transmission bearing failure by allowing proper chain tension of 5/8 to 7/8 in. free play when cold. Available to fit 06-16 Dyna and 07-16 FLT, Softail and Big Twin Harley-Davidson® models.

- Machined from 6061-T6 and hard anodized for durability
- 4140 steel adjusting screw
- Heavy-duty nylon 6/6 shoe
- Uses stock mounting hardware
- Easy to adjust
- For use with 34 tooth sprocket only
- Made in USA

Note: Chain adjustment and tension check will require removal of outer primary cover.



HARLEY-DAVIDSON	Year	P/N	Retail
FLH, FLT	07-16	216094	195.00
FXST, FLST	07-16	216093	195.00
FXD, FLD	06-16	216093	195.00

**DIAMOND PRIMARY CHAIN**

Original equipment on all Harley-Davidson®

- Made in USA



HARLEY-DAVIDSON	Year	O.E.M.	P/N	Retail
FLT, FXR	80-06	40037-79A	120010¹	101.99
XL, XR	57-16	40005-57A	120403²	99.50
Big Twin, Dyna, Softail	36-06	40007-36B	120011³	109.99

¹ 76 links² 94 links, exc. 04-13 model Sportster, 1200cc XR models³ 82 links, 4-Speed models, exc. 04-13 Softail models**EXCLUSIVE****TWIN POWER PRIMARY CHAIN
ADJUSTER PLATE KIT**

The Twin Power™ Primary Chain Adjuster Plate Kit fits your 65-06 Big Twin models (exc. 2006 Dyna), H-D®# 39998-65.



HARLEY-DAVIDSON	Year	P/N	Retail
FLH	65-06	492845	26.95
FXST	84-06	492845	26.95
FLST	86-06	492845	26.95
FXD	91-05	492845	26.95
FXR	82-94	492845	26.95
FX	71-86	492845	26.95

**EXCLUSIVE****TWIN POWER PRIMARY CHAIN ADJUSTER KIT**

Available for 65-06 models in one convenient kit.

HARLEY-DAVIDSON	Year	P/N	Retail
Big Twin	01-06	489623	58.95
Big Twin	65-00	411445	57.95

**EXCLUSIVE****TWIN POWER PRIMARY CHAIN ADJUSTER LININGS**

Keep the proper tension on your primary chain with the Twin Power™ Primary Chain Adjuster Linings.

HARLEY-DAVIDSON	Year	O.E.M.	P/N	Retail
Big Twin	01-06	39976-01	489624¹	7.50
Big Twin	65-00	39976-65B	492796	7.95
XL	77-90	39966-80	492795	6.95

¹ exc. 2006 Dyna

PRIMARY DRIVE

AUDIO, VIDEO
& NAVIGATION

INDIAN
& VICTORY

WINDSHIELDS

SEATS &
SISSY BARS

LUGGAGE

SECURITY
& COVERS

TIRES &
WHEELS

BRAKES

CHASSIS

SUSPENSION

SHEET METAL

EXHAUST

FUEL & AIR
SYSTEMS

ENGINE &
OIL FILTERS

PRIMARY DRIVE

TRANSMISSION
& FINAL DRIVE

GASKETS &
HARDWARE

HANDLEBARS
& CONTROL

CABLES

FOOT
CONTROL

INSTRUMENT
& LIGHTING

ELECTRICAL

BATTERIES &
CHARGERS

TRAILERS
& RAMPS

CHEMICALS
& LUBES

TOOLS &
SUPPLIES

GENERAL
ACCESSORIES
& DISPLAY

CROSS
REFERENCE

INDEX



RIVERA PRIMO IDLER LOCK NUT

Lock nut for the inner primary serrated plate. High-quality, high-performance idler for belt-tensioning with belt-drive kits. Bearing comes with a small serrated plate that attaches to the stock plate found on all inner primary covers.

- If you need a large plate or locking-nut order by part number
- For 1-1/2 in. wide belt systems only
- For use on Rivera Primo Brute II and Brute II Classic 11 mm belt drives
- Made in USA



P/N	Retail
060593	4.57



RIVERA PRIMO SERRATED PLATE

Serrated primary chain adjuster anchor plate. Perfect replacement for worn out anchor plate.

- Made in USA



P/N	Retail
060594	15.56



BAKER™ FINE PITCH ADJUSTER BRACKET AND SHOE

Primary chain adjuster bracket looks like the stock style bracket but has 28% more adjuster teeth. Finer pitch teeth make it easier to dial in your primary chain slack.

- Also available is a fat adjuster shoe for special applications that require it, sold separately
- Made in USA



HARLEY-DAVIDSON	Year	P/N	Retail
FLH	01-06	410746	62.50
FXST, FLST	01-06	410746	62.50
FXD	01-05	410746	62.50



BAKER™ FINE PITCH FAT ADJUSTER SHOE

- Fat adjuster shoe for special applications that require it
- Made in USA



P/N	Retail
410747	41.49



HAYDEN M-6 PRIMARY CHAIN TENSIONER

Now you can have the proper chain tension during acceleration and deceleration with the big benefit of improved shifting. Your transmission will "click" into gear instead of "clunk." Automatically adjusts the primary chain on 65-16 Big Twin, Sportster models. Once installed, the tensioner automatically self-adjusts the tension on the primary chain to provide constant and even tension, improving transition in gear shifting, reducing shift noise making for a smoother ride, as well as extending the life of the primary chain.

- Made in USA



HARLEY-DAVIDSON	Year	P/N	Retail
Big Twin	07-16	155580	130.00
Big Twin	01-06	155979	117.95
Big Twin	65-00	155975	117.95
XL	04-16	155963	117.95
XL	91-03	155978	117.95
XL	77-90	155977	117.95

M-6 Primary Chain Tensioner Replacement Shoe

P/N	Retail
155976	21.99



155580



155975



155977



155963



155979



RIVERA PRIMO GEAR RATIO GAME CHANGER

Reduces the gear ratio from the stock 1.36 to a stouter, better pulling ratio of 1.44. Kit includes everything you will need to convert your O.E. compensator assembly to one that will enable you to pull better on the straight-away and steep inclines.

- Must be used with the 2011 and later compensator assembly; earlier models must be upgraded to the newer compensator
- Includes a 32 tooth comp sprocket plus complete instructions
- Made in USA

Note: Does not come with chain.



HARLEY-DAVIDSON	Year	P/N	Retail
FLH, FLT	14-16	066100	220.23
FLH, FLT	07-13	060565	220.23



BELT DRIVES LTD. COMPENSATOR SPROCKET

Three-piece patented design with no spring. Weighs less than the stock sprocket.

- Made in USA



Teeth	P/N	Retail
24	438840	88.50
25	438841	88.50



BELT DRIVES LTD. COMPENSATOR

CS-34A BDL's new patented chain compensator, 34 tooth.

HARLEY-DAVIDSON	Year	P/N	Retail
FXST, FLST	07-09	670319	197.50



EVOLUTION INDUSTRIES 34 TOOTH MOTOR SPROCKET

This solid 34 tooth motor sprocket conversion eliminates slippage and noise from compensator. Made out of high-strength 4140 tool steel. Heat-treated then black oxide coated. At 4.770 lbs., this sprocket reduces over half the weight (less rotating mass).

- Sprocket bolt kit (sold separately) includes machined and hardened washer
- Made in USA



HARLEY-DAVIDSON	Year	P/N	Retail
Big Twin	11-16	411643 ¹	219.99
Big Twin	07-10	411642	219.99
Screamin' Eagle	07-16	411643 ¹	219.99
Dyna	06-10	411642	219.99

¹ Includes sprocket spacer

EVOLUTION INDUSTRIES 30 TOOTH SPROCKET BOLT KIT

- Made in USA

Note: Evolution Industries recommends installing a sprocket bolt when changing sprocket



P/N	Retail
411635	17.99



EVOLUTION INDUSTRIES 30 TOOTH SPROCKET KITS

Manufactured from aircraft-quality steel. Heat-treated to specifications to insure maximum strength. 2 lbs. lighter than stock. Includes 30 tooth sprocket, custom primary chain and easy-to-follow instruction.

Raises RPM to achieve maximum performance eliminating lugging of motor. Changes stock 1.352 gear ratio to 1.5333 gear ratio. 4th gear 70 MPH @ 3620 RPM to new 4th gear; 70 MPH @ 4500 RPMs; 5th gear 70 MPH @ 3042 RPM to new 5th gear 70 MPH @ about 3750 RPMs; 6th gear 70 MPH @ 2570 RPM to new 6th gear 70 MPH @ about 3250 RPMs.

- Three-year limited manufacturer's warranty
- Made in USA

Note: Evolution Industries recommends installing a sprocket bolt when changing sprocket



HARLEY-DAVIDSON	Year	P/N	Retail
FLH, FLT	11-16	411640	332.99
FLH, FLT	07-10	411633	319.99
FXST, FLST, FXD	11-16	411641	337.99
FXST, FLST	07-10	411634	324.99
FXD	06-10	411634	324.99

PRIMARY DRIVE



EXCLUSIVE

TWIN POWER SPLINED SHAFT MOTOR SPROCKETS

24 tooth, H-D®# 40211-55.

HARLEY-DAVIDSON	Year	P/N	Retail
FLH	55-84	490974	34.50
FX	71-84	490974	34.50

NEW! EXCLUSIVE

TWIN POWER COMPENSATOR ELIMINATORS

- Machined from 4350 Chrome Moly Tool Steel
- Induction hardened
- Eliminates 4-1/4 lbs of spinning weight
- Includes Grade 8 nut and washer
- Made in USA



HARLEY-DAVIDSON	Year	P/N	Retail
FLH, FLT, FXST, FLST, FXD	06-16	216490	198.95
FLH, FLT, FXST, FLST, FXD, FXR	94-06	216088	106.00
FLH, FLT, FXST, FLST, FXD, FXR	84-93	216087	106.00



216490



216088

EXCLUSIVE

TWIN POWER COMPENSATING SPROCKET AND COVER KITS

Replace the stock compensating sprocket easily and economically.

- Kits includes sprocket shaft extension, compensator sprocket, sliding cam, cover assembly and nut.
- Kits must be spaced by installer.

HARLEY-DAVIDSON	Year	P/N	Retail
FLH, FXST, FLST	07-16	496035	299.99
FLH, FLT	02-06	489767	209.95
FLH, FLT	99-01	489765 ¹	199.95
FLH, FLT	94-01	489767 ²	209.95
FXST, FLST	07-11	482885	149.95
FXST, FLST	94-06	489767	209.95
FXD	06-16	496035	299.99
FXD	94-05	489767	209.95
FXR	1994	489767	209.95
Softail, FLH, FLT, FXR, Dyna	91-93	489765	199.95

24 Tooth Sprocket

Complete stock style replacement for the 24-tooth compensating sprocket.

HARLEY-DAVIDSON	Year	O.E.M.	P/N	Retail
Big Twin	91-93	40269-85A	489770 ³	72.95

25 Tooth Sprocket

Complete stock style replacement for the 25-tooth compensating sprocket.

HARLEY-DAVIDSON	Year	O.E.M.	P/N	Retail
Big Twin	94-06	40308-94	489772 ⁴	78.95

34 Tooth Sprocket

Complete replacement late model compensator for 06 Dyna and 07 and later Big Twin.

HARLEY-DAVIDSON	Year	O.E.M.	P/N	Retail
Big Twin	07-11	40320-06	482802	73.95

Slider Cam

Perfect replacement for the stock slider cam.

HARLEY-DAVIDSON	Year	O.E.M.	P/N	Retail
Big Twin	07-11	40333-06	482803	34.95

Extended Shaft Extensions

Perfect for use with offset wide tire conversions.

HARLEY-DAVIDSON	Year	O.E.M.	P/N	Retail
Big Twin	84-90	40375-70	489773 ⁵	39.95

Extended Crankshaft Nut

Perfect for use with offset wide tire conversions.

P/N	Retail
489780	14.95



489767



482803



482802



489770

489772

¹ EFI models

² with carb

³ Big Twin for P/N 489765

⁴ Big Twin for P/N 489767, exc. 2006 Dyna

⁵ Big Twin Stock



603187

603046

**BELT DRIVES LTD. MOTOR NUT KIT**

Replacement motor nut and washer for BDL belt drive applications.

- Made in USA



P/N	Retail
438844	5.00



043964



044189



043960

**COLONY MOTOR SPROCKET NUTS**

O.E.M. 24003-30 replacement style nut.

- Made in USA



Hexed

HARLEY-DAVIDSON	Year	P/N	Retail
EL, FL, FLH	55-76	043964	15.99
EL, FL, FLH	30-54	043944	11.99
FX	71-76	043964	15.99

Acorn

HARLEY-DAVIDSON	Year	P/N	Retail
EL, FL, FLH	55-76	044189	14.99
FX	71-76	044189	14.99
XL	57-16	043960	9.99



400827



400826

NEW!**AIM® VP-LT/INVO CLUTCH**

New VP-LT/Invo fits behind 98-Up, Narrow and Standard Primary Covers and stock Derby Covers without spacer and modification. Lever shape makes a lower profile and lever geometry and tip shape to maintain clutch force.

- High-Performance: 95 IV gives 40% more clamping force
- Street-Performance: 84 IV gives 20% more clamping force and 20% clutch pull reduction
- Easy Clutch Pull: 68 IV gives 40% clutch pull reduction

HARLEY-DAVIDSON	Year	O.E.M.	P/N	Retail
FLH, FLT, FXST, FLST, FXD	98-16	VPO28-68IV	400826 ¹	295.00
FLH, FLT, FXST, FLST, FXD	98-16	VPO27-84IV	400827 ¹	295.00
FLH, FLT, FXST, FLST, FXD	98-16	VPO26-95IV	400828 ¹	295.00

¹ exc. 13-15 CVO

EXCLUSIVE

BIKER'S CHOICE® MOTOR SPROCKET NUTS

HARLEY-DAVIDSON	Year	O.E.M.	P/N	Retail
Big Twin	91-06	40392-91	410155 ¹	15.95
Big Twin	L70-90	40392-70	603187	11.57
Big Twin	55-E70	24003-55	603046	8.50

¹ exc. 2006 Dyna

047734

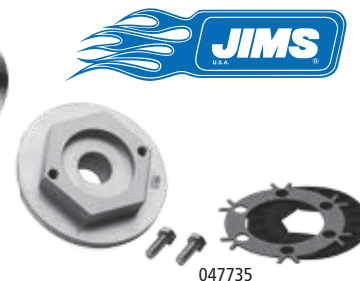

047735

JIMS® COMPENSATOR LOCK KIT

Similar to the bulletproof JIMS® transmission pulley mega-nut, by design, this new compensator lock kit will ensure that your compensator nut cannot come loose causing unnecessary, unsafe and expensive damage.

The lock plate captures the nut and secures it to the sprocket retainer. For added assurance, JIMS® has incorporated a lock tab to ensure the lock plate bolts do not come loose. As if this wasn't enough, the JIMS® compensator kit P/N 047734 incorporates a one-piece sprocket retainer (Replaces H-D®# 37810-08A) for added strength.

Long Retainer

HARLEY-DAVIDSON	Year	O.E.M.	P/N	Retail
FLH, FLT, FXST, FLST, FXD	12-13	83935-09A	047734 ¹	162.20

Short Retainer

HARLEY-DAVIDSON	Year	O.E.M.	P/N	Retail
FLH	2011	40370-08, 83935-09, 40274-08	047735	141.80
FXCW/C	08-11	40370-08, 83935-09, 40274-08	047735	141.80

¹ all O.E.M. compensators

400833



400845

AIM® VP-SDR CLUTCH PERFORMANCE KIT

The new Performance Clutch Coil Spring Kit gives you more capacity when using the VP-SDR for 2013 and later A&S Clutch, three studs-style. Equipped with 40% more clamping force.

HARLEY-DAVIDSON	Year	O.E.M.	P/N	Retail
CVO, Tri-glide	13-16	VPO-25 SDR	400833	345.00
CVO, Tri-glide	13-16	VPO-24 SDR	400845	345.00

PRIMARY DRIVE

AUDIO, VIDEO
& NAVIGATION

INDIAN
& VICTORY

WINDSHIELDS

SEATS &
SISSY BARS

LUGGAGE

SECURITY
& COVERS

TIRES &
WHEELS

BRAKES

CHASSIS

SUSPENSION

SHEET METAL

EXHAUST

FUEL & AIR
SYSTEMS

ENGINE &
OIL FILTERS

PRIMARY DRIVE

TRANSMISSION
& FINAL DRIVE

GASKETS &
HARDWARE

HANDLEBARS
& CONTROL

CABLES

FOOT
CONTROL

INSTRUMENT
& LIGHTING

ELECTRICAL

BATTERIES &
CHARGERS

TRAILERS
& RAMPS

CHEMICALS
& LUBES

TOOLS &
SUPPLIES

GENERAL
ACCESSORIES
& DISPLAY

CROSS
REFERENCE

INDEX



060568



060157

RIVIERA PRIMO TPP VARIABLE PRESSURE CLUTCH ASSIST WITH PRO CLUTCH

Easy on the hand but with increased pack pressure at higher RPM. Easy to pull at the clutch lever when shifting but a dramatic increase in clutching power under the influence of high horsepower. Up to 60% more clutch pack compression, enabling the use of a lighter diaphragm clutch spring for up to 50% easier clutch lever effort with no loss of performance.

HARLEY-DAVIDSON	Year	Mfg/N	P/N	Retail
Big Twin	11-16	1056-0028	060570²	584.95
Big Twin	07-10	1056-0024	060569³	579.95
Big Twin	07-10	1056-0025	060157¹	592.95
Big Twin	98-06	1056-0001	060568⁴	553.50
FXD	06-10	1056-0024	060569	579.95
FXD	06-10	1056-0025	060157¹	592.95

¹ With H-D® Hydraulic Clutch

² with cable clutch

³ with stock style chain basket

⁴ with stock style chain basket, exc. 2006 Dyna



RIVIERA PRIMO BRUTE V REPLACEMENT CLUTCH PACK

Replacement clutch pack with Kevlar® friction plates for Brute V with new-style hub.

HARLEY-DAVIDSON	Year	P/N	Retail
Big Twin	90-06	060171	136.95



RIVIERA PRIMO PRO CLUTCH KIT

Pro Clutch™ kit system provides a significant improvement of clutch engagement to better provide transfer of horsepower. Either clutch kit provides over double the clutch surface area.

- Kit includes new hub and clutch pack and uses the stock clutch basket
- Made in USA



Clutch Kit

HARLEY-DAVIDSON	Year	Mfg/N	P/N	Retail
Big Twin	11-16	1056-0026	060437	499.95
Big Twin	11-16	1056-0027	060567¹	517.95
Big Twin	07-10	1056-0020	060367	499.95
Big Twin	07-10	1056-0022	060566²	499.95
Big Twin	98-06	1056-0006	060366³	499.95
Big Twin	90-97	1056-0005	060365	499.95
Big Twin	85-89	1056-0003	060364	499.95
Dyna	06-10	1056-0020	060367	499.95
XL	91-16	1056-0007	060305	499.95

¹ with Hydraulic Clutch

² models with Screamin Eagle hydraulic clutch actuator

³ exc. 2006 Dyna



060410

RIVIERA PRIMO TPP VARIABLE PRESSURE CLUTCH ASSIST ASSEMBLY ONLY

Easy to pull at the clutch lever when shifting, but a dramatic increase in clutching power under the influence of high horsepower. Up to 60% more clutch pack compression, enabling the use of a lighter diaphragm clutch spring for up to 50% easier clutch lever effort with no loss of performance.

Note: All enclosed chain drive models and Brute III Extreme belt drives require purchase of a derby cover spacer kit.

HARLEY-DAVIDSON	Year	P/N	Retail
Big Twin	98-07	060410¹	336.50
Big Twin	90-97	060393²	289.95
Big Twin	36-84	060409³	281.95

¹ models using BC# 06-0366 Riviera Pro Clutch

² models using BC# 06-0365 Riviera ProClutch

³ models using BC# 06-0363 Riviera Pro Clutch



RIVIERA PRIMO DERBY COVER SPACER KIT

- Required for enclosed primaries

Description	P/N	Retail
For 3-hole derby	060412	34.95
For 5-hole derby	060413	34.95



Complete Clutch Packs

HARLEY-DAVIDSON	Year	Mfg/N	P/N	Retail
Big Twin	11-16	1048-0200	060291	129.95
Big Twin	07-10	1048-0012	060299	145.95
Big Twin	98-06	PC-5A	060303	164.95
Big Twin	90-97	PC-4A	060302	182.95
Big Twin	85-89	PC-3A	060301	144.50
Dyna	06-10	1048-0012	060299	145.95
XL	91-16	1048-0029	060601	157.50
BUELL				
Blast	91-02	1048-0029	060601	157.50

Pro Clutch Kit Replacement Parts

Description	P/N	Retail
Locking Tabs pr	060551	4.95
Shoulder Nut (P/N 060364, P/N 060365) ea	060552	4.50
Shoulder Nut (P/N 060366) ea	060553	3.50
Shoulder Nut (P/N 060367) ea	060554	3.50
Shoulder Nut (P/N 060437) ea	060555	4.50
Friction Plate (P/N 060364 Only)	060156	9.50
Outer Clutch Hub	060173	61.50
Friction Plate for P/N 060366	060379	15.95



060173



RIVERA PRIMO 36-E84 PRO CLUTCH KIT

Kit converts all 36-E84 chain or belt drive clutch baskets to a smooth and easy diaphragm spring operation.

- Chain or belt drive clutch shell
- Explicit instructions are included
- Made in USA

Includes:

- Adaptor with bearing
- Clutch hub
- Friction plate
- Steel-plates
- Stainless-steel pressure plate
- Diaphragm spring
- Spring retainer
- Four shoulder nuts
- Clutch hub with seal



Note: Use Primo Gold Diaphragm Spring for mouse traps.



HARLEY-DAVIDSON	Year	Mfg/N	P/N	Retail
Big Twin	36-E84	1056-0002	060363	499.95



36-E84 Pro Clutch Kit Replacement Parts

Description	P/N	Retail
Locking Tabs pr	060551	4.95
Shoulder Nut (P/N 060437) ea	060555	4.50



RIVERA PRIMO DIAPHRAGM CLUTCH SPRINGS

For Pro Clutch™ and O.E. clutches.

- Made in USA



Black Diaphragm Style Clutch Springs

- 10% stronger than stock for smoother, more positive hand lever engagement
- Perfect for Hot Street or Stokers
- Replaces H-D®# 37871-98

HARLEY-DAVIDSON	Year	P/N	Retail
Evolution Big Twin	90-97	060452	24.95
XL	91-16	060452	24.95

Silver Diaphragm Style Clutch Springs

- 15% stronger than stock
- Replaces H-D®# 37871-90

HARLEY-DAVIDSON	Year	P/N	Retail
Evolution Big Twin	90-97	060453	26.95
XL	91-16	060453	26.95

Gold Diaphragm Style Clutch Springs

- 25% stronger than stock
- Replaces H-D®# 37871-90

HARLEY-DAVIDSON	Year	P/N	Retail
Evolution Big Twin	90-97	060454	24.95
XL	91-16	060454	24.95

RIVERA PRIMO CLUTCH PLATE KIT FOR RIVERA

Description	P/N	Retail
7 Friction, 7 Steel	481108	155.99
9 Friction, 10 Steel	481109	175.50



RIVERA PRIMO STEEL PLATE

- Sold individually

Description	P/N	Retail
.047" thick	060583	9.00
Steel drive plate .080 thick	060600	9.00

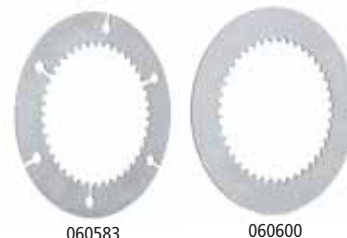

RIVERA PRIMO PRO CLUTCH FRICTION PLATE

Provides a large increase in clutch plate surface for getting the horsepower to the rear wheel.

- Made in USA
- Sold individually



P/N	Retail
060577	9.00



RIVERA PRIMO CLUTCH NUT LOCK TAB

- Stainless steel
- 0.029 in. for use on clutch nuts on Pro Clutch™ and TPP clutch assists
- Made in USA
- Sold individually



P/N	Retail
060499	2.50



BARNETT CLUTCH PLATE KIT FOR RIVERA

Barnett Performance Product's replacement clutch plate kits for Primo-Rivera clutches include their "RQ" friction plates and tempered steel drive plates. RQ friction material provides a smoother, more positive engagement. Tempered steel drive plates are quality checked for flatness to ensure optimum performance.

- Includes eight friction and nine steel plates

P/N	Retail
489595	175.19

AUDIO, VIDEO & NAVIGATION

INDIAN & VICTORY

WINDSHIELDS

SEATS & SISSY BARS

LUGGAGE

SECURITY & COVERS

TIRES & WHEELS

BRAKES

CHASSIS

SUSPENSION

SHEET METAL

EXHAUST

FUEL & AIR SYSTEMS

ENGINE & OIL FILTERS

PRIMARY DRIVE

TRANSMISSION & FINAL DRIVE

GASKETS & HARDWARE

HANDLEBARS & CONTROL

CABLES

FOOT CONTROL

INSTRUMENT & LIGHTING

ELECTRICAL

BATTERIES & CHARGERS

TRAILERS & RAMPS

CHEMICALS & LUBES

TOOLS & SUPPLIES

GENERAL ACCESSORIES & DISPLAY

CROSS REFERENCE

INDEX

PRIMARY DRIVE



BELT DRIVES LTD. LOCK-UP CLUTCH

Lock up clutch for Hydraulic clutch.

- Fits late Touring Models with HD® hydraulic clutch, non-CVO

P/N	Retail
439091	238.50



BELT DRIVES LTD. COMPETITOR CLUTCH KIT

- Includes seven Kevlar® fibers that have more than 60% surface area than stock
- Patented ball bearing lock-up pressure plate

HARLEY-DAVIDSON	Year	P/N	Retail
FLH	98-13	439037	444.09
FXST, FLST	98-13	439037	444.09
FXD	98-13	439037	444.09



BELT DRIVES LTD. BALL BEARING LOCK-UP CLUTCH

- Patent pending
- Standard equipment with all new Belt Drive Ltd. 2 in. belt drives
- Kit available as a retro-fit with all belt drives with coil spring clutch except for Top Fuel drives

P/N	Retail
438928	209.48

BARNETT PRESSURE PLATE CLUTCH SPACERS

Stock 1.525 in. used to assist in adjusting the pressure plate (releasing disc).

- Sold as set of six

P/N	Retail
489596	3.09



BELT DRIVES LTD. KEVLAR CLUTCH KITS

Clutch plates are made of either 6061-T6 or high-tempered steel with Belt Drives Ltd. race-proven Kevlar® material. Each plate design was tested so that the maximum performance is achieved. Different groove patterns were designed for maximum oil circulation and heat dissipation.

- Made in USA



HARLEY-DAVIDSON	Year	Friction/ Steel Plates	Mfg/N	P/N	Retail
Big Twin	98-16	9/8	BTX-14	439136	139.00
Big Twin	90-97	8/6	BTX-11	439135	126.00
Big Twin	L84-89	6/7	BTX-9	439134	111.00
Big Twin	68-E84	5/4	BTX-5	439133	96.00
XL	91-16	8/6	BTX-11	439135	126.00



BELT DRIVES LTD. KEVLAR EXTRA PLATE KIT

Kevlar® friction plates on tempered-steel cores. Starburst groove pattern for maximum heat dissipation and oil circulation. 15% more clutch area for high performance strokers. 15% more surface area.

- Made in USA



HARLEY-DAVIDSON	Year	P/N	Retail
Big Twin	98-16	438837	198.50
Big Twin	90-97	438836	146.50
XL	91-16	438836	146.50

BELT DRIVES LTD. FRICTION DISCS AND RIVETS

Teflon clutch hub lining. Improves the performance of your clutch whether run wet or dry.

- Replacement rivets included (8 +1 spare)
- Made in USA



HARLEY-DAVIDSON	Year	P/N	Retail
Big Twin	41-84	438839	9.50



EVOLUTION INDUSTRIES DIAMOND TERMINATOR STAGE 1 CLUTCH KITS

From strip to street the Diamond Terminator is the ultimate clutch kit. Diamond Terminator clutch kits are the best solution for getting horsepower and torque to the ground. Increased friction surface to handle up to 220 horsepower. Machined oil grooves to insure zero slippage with 105% more friction area than stock. Runs in wet or dry applications.

- Diamond Tough billet-steel drive hub
- Two sets of coil springs, light performance yellow and blue performance spring installed
- Instructions included for easy installation
- Made in USA
- Not compatible with synthetic fluids



HARLEY-DAVIDSON	Year	P/N	Retail
FLH, FLT, FXST, FLST	07-10	411650	505.99
FLH, FLT, FXST, FLST, FXD	98-06	411651¹	505.99
FLH, FLT, FXST, FLST, FXD	90-97	411652	505.99
FXD	06-10	411650	505.99

¹ exc. 06 Dyna



Replacement Clutch Packs

HARLEY-DAVIDSON	Year	P/N	Retail
FLH, FLT, FXST, FLST	07-10	411656	143.95
FLH, FLT, FXST, FLST, FXD	98-06	411657	143.95
FLH, FLT, FXST, FLST, FXD	90-97	411658	137.95
FXD	06-10	411656	143.95

Upgrade Spring Kit for Stage 1 Clutch Kits

- Not compatible with synthetic fluids

Description	P/N	Retail
Blue	411659	34.95
Red	411660	34.95



EVOLUTION INDUSTRIES DIAMOND TERMINATOR SERIES D CLUTCH

From strip to street the Diamond Terminator is the ultimate clutch kit. Diamond Terminator clutch kits are the best solution for getting horsepower and torque to the ground. Increased friction surface to handle extreme horsepower. Machined oil grooves to insure zero slippage with 105% more friction area than stock. Runs in wet or dry applications. Instructions included for easy installation. Recommended primary fluid ATF automatic transmission fluid, also compatible with all V-Twin primary fluids.

- Diamond Tough billet steel drive hub
- Two sets of diaphragm springs are included, light-performance and heavy-performance spring installed
- Kevlar® Terminator friction plates with tempered steels
- Made in USA
- Not compatible with synthetic fluids



HARLEY-DAVIDSON	Year	P/N	Retail
FL, FLH, FX	36-84	411653	505.99



Replacement Clutch Packs

HARLEY-DAVIDSON	Year	P/N	Retail
FL, FLH, FX	36-84	411661	148.95

Upgrade Spring Kit for Series D Clutch Kits

Description	P/N	Retail
Blue	411659	34.95
Red	411660	34.95

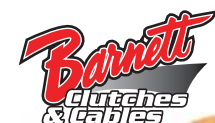

BARNETT SCORPION CLUTCHES

Billet steel and aluminum clutch. Smooth, positive engagement and release for finding neutral and positive shifting. Steel spacers on clutch pack ends assure no wear on aluminum surfaces. Six heavy-duty springs instead of stock diaphragm.

- Kit includes extra springs for tuning the clutch
- Easy tunability without removal of primary cover
- Compatible with any primary oil

Clutch

HARLEY-DAVIDSON	Year	P/N	Retail
Big Twin	11-16	498988	550.00
Big Twin	07-10	498402	550.00
Big Twin	07-10	498401¹	550.00
Big Twin	98-06	498351²	550.00
Big Twin	90-97	498350	550.00
Big Twin	36-84	481113	550.00
Dyna	2006	498402	550.00
Sportster	91-16	498349	550.00
Sportster	86-90	481111	550.00
Sportster	71-85	481112	550.00

¹ Hydraulic Clutch
² exc. 2006 Dyna

Replacement Clutch Kits

HARLEY-DAVIDSON	Year	P/N	Retail
Big Twin	98-16	498012	206.59
Big Twin	90-97	498015	188.49
Big Twin	84-89	481107	151.95
Big Twin	41-84	489520	164.99
Sportster	91-16	498016	193.59

Clutch Lock Plates

HARLEY-DAVIDSON	Year	P/N	Retail
Big Twin	98-10	498650	24.20
Big Twin	90-97	498649	24.20
Sportster	91-16	498649	24.20
Sportster	84-90	498650	24.20

PRIMARY DRIVE



BARNETT LOW PROFILE LOCK-UP PRESSURE PLATE

Designed specifically to fit under stock or aftermarket primary/derby covers. Increases the capacity of your stock clutch and keeps lever effort to a minimum even with big inch motors. Stainless steel weighted arms progressively increase pressure to the clutch as RPM's increase. Three different sets of six coil springs (light, medium, heavy) are included for a wide variety of spring pressure options. The coil spring design provides smoother shifting and a more linear engagement compared to a diaphragm type spring.

- Easy bolt-on installation. No modifications required
- Simply replaces the O.E.M. pressure plate/diaphragm spring assembly
- CNC precision-machined black anodized billet aluminum pressure plate
- Polished aluminum lock-up head
- Chrome Torx derby cover fasteners included
- Coil springs are made from chrome silicon, heat-treated and pre-set
- Made in USA



HARLEY-DAVIDSON	Year	P/N	Retail
Big Twin	98-16	497667¹	475.00
Big Twin	98-16	497669²	475.00

¹ with cable clutch

² with hydraulic clutch



497667

Low Profile Lock-Up Pressure Plate Replacement Springs

Coil springs are made from chrome silicon, heat-treated and pre-set.

Description	P/N	Retail
Red Clutch Springs (set of 6)	490747	22.19

BARNETT CLUTCH PLATE KITS FOR HARLEY-DAVIDSON

Made with Kevlar® or Barnett's exclusive carbon fiber friction plates. Friction plates feature a "segmented" design, which increases oil flow and allows the plates to run cooler for longer life and smoother, more consistent performance. Carbon fiber friction material has a very high tolerance for heat making it an ideal choice for street or track. Drive plates are made from tempered steel and quality checked for flatness. All complete clutch kits are pre-measured for proper stack height to ensure smooth, reliable performance right out of the box.

- Made in USA



HARLEY-DAVIDSON	Year	Friction/		P/N	Retail
		Steel Plates	Mfg/N		
Big Twin	98-16	9/8	306-30-20018	498656	201.99
Big Twin	90-97	8/6	306-30-20016	498655¹	166.79
Big Twin	L84-89	6/7	306-30-20017	498197	139.49
Big Twin	68-E84	5/0	302-30-3005	498037	101.20
XR1200	09-13	8/7	306-30-20015	498118	181.19
Sportster	91-16	8/6	306-30-20016	498655¹	166.79
Sportster	L84-90	7/5/1	303-30-20014	498183¹	177.19
V-Rod	08-16	9/8/4	303-30-20040	498120	195.69
V-Rod	02-07	9/8/5	303-30-10015	498040	187.89

BUELL

XB9, XB12	03-08	8/7	306-30-20015	498118	181.19
Buell	91-02	8/6	306-30-20016	498655¹	166.79

¹ Reuse O.E.M. double steel spring plate



498032

498182

BARNETT KEVLAR AND CARBON FIBER EXTRA PLATE KITS

Barnett's new "segmented" friction material design increases oil flow through the clutch and provides a smoother, more consistent performance and extended clutch life. Kits feature race proven Carbon or Kevlar® "segmented" friction plates and tempered steel drive plates and an increase clutch surface area by 11%-28%, depending on kit/application. V-Rod kits also include heavy-duty clutch springs. Clutch kits are measured for proper stack height prior to packaging to ensure optimal performance.

- Made in USA



Kevlar

HARLEY-DAVIDSON	Year	Friction/		P/N	Retail
		Steel Plates	Mfg/N		
Big Twin	98-16	10/9	307-30-10013	498041	207.99
Big Twin	90-97	9/8	307-30-10011	498032	181.19
Big Twin	68-E84	6/10	304-30-10005	498042¹	145.99
Sportster	91-16	9/8	307-30-10011	498032	181.19
Sportster	L84-90	9/8	307-30-10090	498089	205.29
Sportster	1970	8/1/6	303-30-10010	489517	114.19
V-Rod	02-07	10/9/5	304-30-10015	498043	201.99

BUELL

Buell	91-02	9/8	307-30-10011	498032	181.19
-------	-------	-----	--------------	---------------	---------------

¹ Will fit 1941-67 models but requires one additional steel plate, P/N 498046

Carbon Fiber

HARLEY-DAVIDSON	Year	Friction/		P/N	Retail
		Steel Plates	Mfg/N		
Big Twin	98-16	10/9	307-30-20013	498182	216.19
Big Twin	90-97	9/8	307-30-20011	498029	187.69
Sportster	91-16	9/8	307-30-20011	498029	187.69
V-Rod	02-07	10/9/5	304-30-20015	498185	211.09

BUELL

Buell	91-02	9/8	307-30-20011	498029	187.69
-------	-------	-----	--------------	---------------	---------------



Carbon Fiber

Kevlar

BARNETT CLUTCH FRICTION PLATES

- Available in Kevlar® and carbon fiber
- Designed to perform under extreme heat conditions
- Kevlar® plates designed for increased durability
- Carbon fiber plates have high static and dynamic coefficient of friction for smooth positive engagement and release

HARLEY-DAVIDSON	Year	No. of Plates in Kit	O.E.M.	Type	P/N	Retail
Big Twin	98-16	9	37932-98	Carbon Fiber	498027	146.99
Big Twin	98-16	9	37932-98	Kevlar	498035	136.65
Big Twin	90-97	8	37911-90	Carbon Fiber	498033	126.99
Big Twin	90-97	8	37911-90	Kevlar	498034	114.99
Big Twin	L84-89	6	37931-84	Carbon Fiber	498031	101.20
Big Twin	L84-89	6	37931-84	Kevlar	498048	91.10
Big Twin	68-E84	5	37930-68A	Kevlar	498044	88.55
Big Twin	41-67	5		Carbon Fiber	498037¹	101.20
Big Twin	68-75	7	37985-52	Carbon Fiber	489448	106.29
Flathead 45	29-53	3		Carbon Fiber	481106	50.95
Sportster	91-16	8	37911-90	Carbon Fiber	498033	126.99
Sportster	91-16	8	37911-90	Kevlar	498034	114.99
Sportster	L84-90	7	36788-84	Carbon Fiber	498184	113.99
Sportster	L84-90	7	36788-84	Kevlar	498090	106.99
Sportster	71-E84	8	37985-71A	Kevlar	498186	121.99
Sportster	71-85	1	37987-71	Kevlar	489445²	10.09
Sportster	1970	7	37985-52	Carbon Fiber	489448	106.29
Sportster	1970	1		Sintered	481105³	30.50
BUELL						
Buell	91-02	8		Carbon Fiber	498033	126.99
Buell	91-02	8		Kevlar	498034	114.99

¹ For use wet or dry applications² One-sided only³ 0.140" Dry Plate

482037



498036

498046

NEW! [EXCLUSIVE]**TWIN POWER™ CLUTCH KITS**

- Kits include fiber and steel plates
- Race-proven friction material
- Tempered steel drive plates
- Extra plate kits include a 15% stronger diaphragm spring for increased surface area and greater torque capacity
- Made in USA



HARLEY-DAVIDSON	Year	Friction/ Steel Plates	P/N	Retail
FLH, FLT, FXST, FLST, FXD	98-16	9/8	482036¹	162.95
FLH, FLT, FXST, FLST, FXD	98-16	10/9	482038^{1, 2}	198.00
FLH, FLT, FXST, FLST, FXD, FXR	90-97	8/6	482035	131.95
FLH, FLT, FXST, FLST, FXD, FXR	90-97	9/8	482037²	158.50
FLH, FLT	85-89	6/7	482034	120.95
FXST, FLST	84-89	6/7	482034	120.95
FL, FLH, FX	41-84	5/4	482033	114.50
XL	91-16	8/6	482035	131.95
XL	91-16	9/8	482037²	158.50

¹ 1998 and later kits should not be used in 2013 and later CVO and SE models² Extra plate kit, stronger spring**ALTO CARBONITE CLUTCH KITS**

Carbonite® based friction material: offers superior coefficient of friction, provides higher temperature capacity, decreases wear while increasing durability. High-performance, heavy-duty O.E.M. replacement. Same lever pull and feel as O.E.M.

- Available manufacturer's lifetime warranty
- Made in USA



HARLEY-DAVIDSON	Year	Friction/ Steel Plates	P/N	Retail
Big Twin	98-16	10/9	498221	174.99
Big Twin	90-97		498220¹	174.99
Big Twin	41-83	6/5	498218	174.99
XL	91-16		498220¹	174.99

¹ Includes nine externally splined, single sided friction plates, nine internally splined, single sided friction plates and one double sided friction plate**BARNETT STEEL DRIVE PLATES**

- Made in USA
- Sold individually



HARLEY-DAVIDSON	Year	Qty. Req.	O.E.M.	P/N	Retail
Big Twin	98-16	8	37913-98	498039	6.59
Big Twin	90-97	6	37913-90	498036²	6.59
Big Twin	L84-89	7	37975-84	498030	6.59
Big Twin	68-E84	4	37975-41	498046¹	11.89
Big Twin	41-67	4	37975-41	498046¹	11.89
XL	91-16	6	37913-90	498036²	6.59
XL	L84-90	6	36787-84	498066	6.59
XL	71-E84	8	37992-71	498187	8.59
XL	1970	1	37992-52	489597	6.59
XL	1970	1	37992-52	481110	6.95

BUELL

Buell	91-02	6		498036²	6.59
-------	-------	---	--	---------------------------	-------------

¹ Reuse stock double, riveted drive plate² Models 41-67 require 3 plates, 68-94 require 4 plates**BARNETT REPLACEMENT CLUTCH KIT FOR BDL**

The RQ friction material in the friction plates provides a smoother, more positive engagement and the tempered-steel drive plates are quality checked for flatness to ensure optimum performance.

- Includes seven friction and seven steel plates

P/N	Retail
489519	151.89



PRIMARY DRIVE



498060



498056

BARNETT REPLACEMENT CLUTCH SPRINGS

- Standard and heavy-duty available
- Made in USA
- Diaphragm spring sold individually; coil springs sold in a pack



Heavy-duty

HARLEY-DAVIDSON	Year	P/N	Retail
Big Twin	98-16	498114	32.59
Big Twin	90-97	498060	32.59
Big Twin	L84-89	498058	32.59
Big Twin	68-E84	498188	27.99
Big Twin	41-67	498188	27.99
XL	91-16	498060	32.59
XL	L84-90	498059	26.09
V-Rod	02-07	498249	18.29

BUELL

Buell	91-02	498060	32.59
-------	-------	---------------	--------------

Standard

HARLEY-DAVIDSON	Year	P/N	Retail
Big Twin	98-16	498061	32.59
Big Twin	68-E84	498056	27.39
Big Twin	41-67	498050	27.39
V-Rod	08-16	498248	14.39



ALTO KEVLAR CLUTCH FRICTION PLATES

No. of Plates

HARLEY-DAVIDSON	Year	In Kit	O.E.M.	P/N	Retail
Big Twin	98-16	9	37932-98	488681	77.99
Big Twin	98-16	1	37932-98	488687	9.50
Big Twin	90-97	8	37911-90	488677	79.99
Big Twin	90-97	1	37911-90	488675	10.50
Big Twin	L84-89	6	37931-84	488679	62.99
Big Twin	L84-89	1	37931-84	488686	11.50
Big Twin	68-E84	5	37930-68A	488680	54.99
Big Twin	41-67	4	37930-68	488678	57.99
XL	91-16	8	37911-90	488677	79.99
XL	91-16	1	37911-90	488675	10.50
XL	L84-90	7	36788-84	488676	80.99
XL	L84-90	1	36788-84	488667	11.95
XL	71-83	8	37985-71	488682	72.99
XL	71-83	1	37985-71	488673	8.50
XL	57-70	1	37985-52	488669	11.00



RIVERA PRIMO COIL TYPE CLUTCH SPRINGS

- Sold in sets of 10

HARLEY-DAVIDSON	Year	O.E.M.	Mfg/N	P/N	Retail
Big Twin	41-84	38075-68	3057-0002	060496¹	19.50
Big Twin	68-84	38075-68	3057-0001	060497²	19.50
Big Twin	41-67	38075-41	3059-0008	060521	35.50
XL	71-84		3059-0002	060498	19.50

¹ Models with 5 plate clutch, 65 lbs. pressure at 1-1/8" spring height

² Models with 5 plate clutch, 50 lbs. pressure at 1-1/8" spring height



ALTO RED EAGLE CLUTCH FRICTION PLATE KITS

Manufactured using a special lining with unique high frictional properties and heat resistance. Good for O.E.M. replacement.

- Made in USA



No. of Plates

HARLEY-DAVIDSON	Year	In Kit	O.E.M.	P/N	Retail
Big Twin	98-16	9	37932-98	411500	73.99
Big Twin	90-97	8	37911-90	498202	41.99
Big Twin	90-97	8	37911-90	488674	4.99
Big Twin	L84-89	6	37931-84	498208	31.99
Big Twin	L84-89	6	37931-84	488685	4.99
Big Twin	68-E84	5	37930-68A	498207	32.99
Big Twin	68-E84	5	37930-68A	488683¹	32.50
Big Twin	41-67	4	37930-68	498228	5.99
XL	91-16	8	37911-90	498202	41.99
XL	91-16	8	37911-90	488674	4.99
XL	L84-90	7	36788-84	498201	48.99
XL	L84-90	7	36788-84	488666	6.99
XL	71-83	8	37985-71	498222	42.99
XL	71-83	8	37985-71	488672	3.99
XL	57-70	7	37985-52	498225	51.99
XL	57-70	7	37985-52	488668	7.98

¹ Includes Back Plate

ALTO REPLACEMENT CLUTCH SPRINGS

- Made in USA
- Sold individually



HARLEY-DAVIDSON	Year	O.E.M.	P/N	Retail
Big Twin	98-16	37871-98A	498217	10.99
Big Twin	L84-89	37871-84	498212	14.24



498217

ALTO BACKPLATE WITH RIVETS

HARLEY-DAVIDSON	Year	P/N	Retail
FLH	1941-84	488684	6.99
FX	71-84	488684	6.99



ALTO STEEL DRIVE PLATES

High-quality steel plates for high-performance and durability.

- Made in USA
- Sold individually



HARLEY-DAVIDSON	Year	Plates	O.E.M.	Plate Kits	Retail	Plate (ea)	Retail
Big Twin	98-16	8	37913-98	498441	46.99	498214	6.49
Big Twin	90-97	6	37913-90	498442	46.99	498206	5.49
Big Twin	L84-89	7	37975-84	498443	37.99	498211	5.49
Big Twin	68-E84	4	37975-41	498444	22.99	498210¹	8.49
Big Twin	68-E84	4		498447¹	41.99		
Big Twin	41-67	3	37975-41	498229¹	31.99		
XL	91-16	6	37913-90	498442	46.99	498206	5.49
XL	L84-90	5	36787-84	498445	28.99	498205	5.49
XL	71-83	8	37991-71	498446	41.99	498223	6.99
XL	57-70	7	37992-52	498227	39.99		
XL	57-70					488670²	5.50
XL	57-70					488671³	5.50

¹ With Anti-Rattlers

² .047"

³ .079"





KIBBLEWHITE® CLUTCH SPRINGS

Replaces both the inner and outer spring with one heavy-duty spring.

- Coil type
- Made in USA



HARLEY-DAVIDSON	Year	P/N	Retail
XL	70-83	499350	18.50



BARNETT CLUTCH CONVERSION

Converts stock diaphragm spring to coil spring. Increases tunability of clutch. More positive linear clutch action.



HARLEY-DAVIDSON	Year	P/N	Retail
FLH	98-16	498352	169.99
FXST, FLST	98-16	498352	169.99
FXD	98-16	498352	169.99

ALTO SPRING SEPARATOR

- H-D®#37977-90
- Made in USA



HARLEY-DAVIDSON	Year	P/N	Retail
FLH	90-97	498213	54.99
FXST, FLST	90-97	498213	54.99
FXR	90-97	498213	54.99
XL	91-16	498213	54.99

499350



EXCLUSIVE

TWIN POWER ALUMINUM CLUTCH PRESSURE PLATE

The Twin Power™ Aluminum Clutch Pressure Plate is the perfect O.E.M. replacement for H-D®#37912-91A.

HARLEY-DAVIDSON	Year	P/N	Retail
FLH	90-97	489600	16.50
FXST, FLST	90-97	489600	16.50
FXR	90-97	489600	16.50
XL	91-16	489600	16.50



EXCLUSIVE

TWIN POWER REPLACEMENT CLUTCH KIT

A quality replacement for 68-84 Big Twins with dry clutch. Set a high standard for performance and durability with the Twin Power™ Replacement Clutch Kit.

HARLEY-DAVIDSON	Year	P/N	Retail
FLH	68-E84	492496	51.95
FX	71-E84	492496	51.95



EXCLUSIVE

TWIN POWER PRESSURE PLATE

Perfect replacement spring retainer for 3-, 5-, or 10-stud clutch hubs. This is an economical replacement for your original 3-hole pressure plate.

- This can be used on 5-stud, P/N 492705 and 10-stud clutch hubs, H-D®#38010-41.

HARLEY-DAVIDSON	Year	P/N	Retail
FLH	41-E84	492917	7.50
FX	71-E84	492917	7.50



EXCLUSIVE

TWIN POWER CLUTCH CONTROL KIT

Control clutch jerking and get a smooth release on stud type clutches with this kit. This kit holds the clutch basket in proper position to eliminate clutch jerking or walking. It may be used on rear chain or belt-driven 4- or 5-speed models.

HARLEY-DAVIDSON	Year	P/N	Retail
FLH	41-E84	492505	49.95
FX	71-E84	492505	49.95



EXCLUSIVE

TWIN POWER RELEASING DISC

Polished cast aluminum releasing disc fits all stud-type Big Twin clutches. These premium Releasing Discs are made from precision-machined and polished die-cast aluminum. They feature a threaded-steel insert for adjusting screws, which eliminates flexing and warping. They fit your 41-E84 Big Twin, H-D®#37805-83T.

P/N	Retail
492406	30.50



ALTO STEELS WITH BUFFER

- Direct O.E.M.-type replacement
- Comes complete with buffer elements
- H-D®#37975-41

HARLEY-DAVIDSON	Year	P/N	Retail
FLH	41-E84	492432	12.49
FX	71-E84	492432	12.49



PAUGHCO

PAUGHCO RELEASING DISC

O.E.M.-style releasing disc.

- H-D®#37871-41
- Made in USA



HARLEY-DAVIDSON	Year	P/N	Retail
FLH	41-E84	599230	42.95
FX	71-E84	599230	42.95



PRIMARY DRIVE



BURLY BRAND LITE CLUTCH

Reduces effort required to pull clutch lever by 40%, which lessens rider fatigue and provides smoother, easier clutch action. Ideal for women riders or stop-and-go traffic. Fits inside the primary cover on Sportster models and the transmission cover on Big Twin models. Extends the clutch operating mechanism for improved leverage. Can be installed in under 30 minutes.

- Made in USA



HARLEY-DAVIDSON	Year	P/N	Retail
FXST, FLH, FLT, FXD	00-16	070670	34.95
FXCW/C	08-11	070670	34.95
FX/FLST, FLT, FLHT, FLHS, FLHR	87-99	070671	34.95
FXD	91-99	070671¹	34.95
Sportster	86-93	070672	34.95

¹ exc. FXR, FRXR, FXLR, FXRT, FXRS-SP



EXCLUSIVE

TWIN POWER LATE STYLE CLUTCH RELEASE KIT

This is a complete throw out bearing and pushrod repair kit.

- Includes oversize throw-out bearing, oil slinger, clutch pushrod, release finger and all necessary bushings and clips

Clutch Release Repair Kit

A complete heavy-duty clutch release kit for 4-speed Big Twins.

HARLEY-DAVIDSON	Year	O.E.M.	P/N	Retail
FL, FX	70-E84	37305-70	492837	43.95

Bearing Kit Only

A heavy-duty clutch release bearing kit for 4-speed Big Twins. This kit may be used as an O.E.M. replacement or as a replacement bearing for our clutch release repair kit.

Includes: Kit includes oversized throw-out bearing, oil slinger, adaptor bushing and clip.

HARLEY-DAVIDSON	Year	O.E.M.	P/N	Retail
FL, FX	L75-E84	37312-75	492838	18.95

Oil Slinger Only

Replacement oil slinger for heavy-duty throw-out bearing kit.

HARLEY-DAVIDSON	Year	O.E.M.	P/N	Retail
FL, FX	75-85	37228-75	603165	5.95



EASTERN O.E.M. STYLE CLUTCH ROD BEARING KIT

- H-D®#37312-75

HARLEY-DAVIDSON	Year	P/N	Retail
FLH	75-16	603167	12.95
FXST	84-16	603167	12.95
FLST	86-16	603167	12.95
FXD	91-16	603167	12.95
FXR	82-94	603167	12.95
FX	75-86	603167	12.95



488716



488715



EXCLUSIVE

TWIN POWER EASY PULL CLUTCH KIT

Reduce clutch lever effort with this easy to install kit.

HARLEY-DAVIDSON	Year	P/N	Retail
FXST, FLT, FLH, FXD	00-16	488716	27.95
FLT, FLHT, FLHS, FLHR	87-99	488715	19.95
FXST, FLST	87-99	488715	19.95
FXD	91-99	488715	19.95
FXRP	87-94	488715	19.95
Sportster	86-90	488715	19.95

EXCLUSIVE

TWIN POWER CLUTCH RAMP KIT

Everything you need for conversion or replacement.

- Includes the inner and outer ramps
- Kit comes with a coupler, clip and the three balls



HARLEY-DAVIDSON	Year	P/N	Retail
FLH	87-06	411046	26.95
FXST, FLST	87-06	411046	26.95
FXD	91-05	411046	26.95
FXR	87-94	411046	26.95

BAKER™ THROW OUT BEARING KIT

The heavy-duty throw out bearing kit was developed to address the failures of the stock clutch throw out bearing. Failures occur when the clutch cable is inadvertently adjusted with little to no free play. Performance clutches are even harder on that little bearing.

- Includes bearing and ball ramp actuator



HARLEY-DAVIDSON	Year	P/N	Retail
FLH	87-16	410643	79.91
FXST, FLST	87-16	410643	79.91
FXD	91-16	410643	79.91
FXR	87-94	410643	79.91



603197



603265



492691

EXCLUSIVE

TWIN POWER THROW OUT BEARINGS

High-quality replacement throwout bearings for all Big Twin models.

- Made in USA



HARLEY-DAVIDSON	Year	O.E.M.	P/N	Retail
Big Twin	70-16	37312-75	603197¹	4.99
Big Twin	70-16	37313-80	603265²	3.99
FL, FX	1937-E75	37310-39	492691	60.50

¹ needle bearing
² race bearing



603481



603482



603484



603576

EASTERN CLUTCH PUSHROD PARTS

HARLEY-DAVIDSON	Year	Description	O.E.M.	P/N	Retail
Big Twin	90-16	Clutch Adjust Plate	37903-90	603481¹	10.95
Big Twin	L84-16	Clutch Adj Screw Lock Nut	7848W	603484¹	6.20
Big Twin	84-16	Clutch Pushrod Retaining Ring	11096A	603482²	2.50
Big Twin	84-89	Clutch Adjust Plate	37903-84	603564	8.99
FLH	85-86	Clutch Pushrod Kit		603577	27.99
FLH	80-84	Clutch Pushrod Kit		603576	27.99
Softail	84-86	Clutch Pushrod Kit		603578	27.99
XL	84-16	Clutch Nut Adjuster	11730A	603579	1.95
XL	84-93	Clutch Adjuster Screw	11735B	603507	4.99
XL	67-70	Clutch Releasing Kit	37280-80	603559	32.99

¹ exc. 2014 FLHT, FLHX models

² 10 Pack



603499



603513



603557



603558



603560



603561



603562



603566



603569



603573

EASTERN CLUTCH REPLACEMENT PARTS

HARLEY-DAVIDSON	Year	Description	O.E.M.	P/N	Retail
Big Twin	90-16	Clutch Hub Nut	37496-90	603561	10.99
Big Twin	90-16	Clutch Pressure Plate Retaining Ring	37909-90	603580	3.25
Big Twin	90-97	Clutch Pressure Plate Retaining Ring	37908-90	603584	3.25
Big Twin	87-16	Clutch Cable Coupling	34920-86	603536	8.99
Big Twin	90-10	Clutch Hub Bearing	37906-90	603566	42.99
Big Twin	90-97	Clutch Seat Spring, Center	37872-90	603583	4.25
Big Twin	87-06	Inner Ramp	25452-87A	603513	11.99
Big Twin	87-16	Ramp Retaining Ring	10998	215577	6.50
Big Twin	84-89	Clutch Hub Nut	37496-84	603560	7.99
Big Twin	00-16	Clutch Hub Retaining Ring	37905-00	603582	3.25
Big Twin	90-99	Clutch Hub Retaining Ring	37905-90	603581	3.25
Big Twin	84-89	Clutch Hub Retaining Ring	37905-84	603565	2.99
Big Twin	37-84	Clutch Hub Roller Bearings (20 PK.)	9540A	603575	8.99
Big Twin	41-84	Clutch Hub Nut	37496-41	603586	7.50
Big Twin	41-84	Clutch Hub Nut Locktab Washer	37503-41	603587	1.20
XL	91-16	Clutch Cable Coupling	34920-86	603536	8.99
XL	91-16	Clutch Pressure Plate Retaining Ring	37908-90	603584	3.25
XL	91-16	Clutch Seat Spring, Center	37872-90	603583	4.25
XL	84-90	Clutch Seat Spring, Center	36793-84	603557	2.99
XL	91-16	Clutch Hub Retaining Ring	37905-90	603581	3.25
XL	84-90	Clutch Hub Retaining Ring	36798-84	603558	1.99
XL	84-90	Clutch Hub Spacer	5707	603569	3.99
XL	71-84	Clutch Hub Retaining Ring	11052	603499	1.99
XL	71-E84	Clutch Cable Coupling	34920-71	603537	11.99
XL	71-79	Ratchet Plate Rivets (100 PK.)	8216	603573	5.50
XL	67-70	Clutch Hub Drum Spacer	37568-67	603562	22.99
XL	54-70	Clutch Hub Stud Nuts	37582-52	603563	11.99



603575



215577

PRIMARY DRIVE

AUDIO, VIDEO
& NAVIGATION

INDIAN
& VICTORY

WINDSHIELDS

SEATS &
SISSY BARS

LUGGAGE

SECURITY
& COVERS

TIRES &
WHEELS

BRAKES

CHASSIS

SUSPENSION

SHEET METAL

EXHAUST

FUEL & AIR
SYSTEMS

ENGINE &
OIL FILTERS

PRIMARY DRIVE

TRANSMISSION
& FINAL DRIVE

GASKETS &
HARDWARE

HANDLEBARS
& CONTROL

CABLES

FOOT
CONTROL

INSTRUMENT
& LIGHTING

ELECTRICAL

BATTERIES &
CHARGERS

TRAILERS
& RAMPS

CHEMICALS
& LUBES

TOOLS &
SUPPLIES

GENERAL
ACCESSORIES
& DISPLAY

CROSS
REFERENCE

INDEX



COLONY THROWOUT BEARING ASSEMBLY

- Replaces O.E.M. 37287-41

HARLEY-DAVIDSON	Year	P/N	Retail
Flatheads	1941-73	044033	61.99



EASTERN CLUTCH RETAINING RINGS

- Fits L75-15 Big Twin clutch pushrod and throw-out bearing
- H-D® # 11096
- Sold in packs of 10

HARLEY-DAVIDSON	Year	P/N	Retail
FLH	75-16	601509	2.50
FXST	84-16	601509	2.50
FLST	86-16	601509	2.50
FXD	91-16	601509	2.50
FXR	82-94	601509	2.50
FX	75-86	601509	2.50



RIVERA PRIMO SEALED CLUTCH HUB NUT AND ADJUSTOR

Prevents leakage of fluids through the mainshaft when using a belt drive system.

- Kit includes clutch hub nut with O-ring and adjuster screw with nut
- For splined shaft
- For use with primary belt drive systems ONLY

P/N	Retail
060576	19.31

RIVERA PRIMO CLUTCH HUB NUT AND ADJUSTOR WITH O-RING

Prevents leakage of fluids through the mainshaft when using a belt drive system.

- Kit includes clutch hub nut with O-ring and adjuster screw with nut
- For tapered shaft

P/N	Retail
060596	19.59



NEW!

MOTION PRO® CLUTCH ADJUSTER NUT TOOL

For use on all 1998 and later models excluding applications with hydraulic clutches. Deep socket allows tool to recess into clutch basket and can be driven with 11/16 in. combination wrench or adjustable wrench. Through hole allows access with hex wrench to hold clutch adjuster screw while simultaneously tightening the adjuster lock-nut.

- Heavy-duty tool for shop or home use
- Compact design fits easily in the saddle bag or tool wrap

P/N	Retail
080548	11.50



BENDER CYCLE CLUTCH PUSHRODS

- Made in USA



Late Models

HARLEY-DAVIDSON	Year	O.E.M.	P/N	Retail
FL, FX	75-E84	37285-75A	609028	9.54
FL, FX	70-74	37285-70	609029	6.36
FL	65-69	37285-65	609030	6.36
FL	1938-64	37285-38	609031	6.36

Left

HARLEY-DAVIDSON	Year	O.E.M.	P/N	Retail
Big Twin	98-16	37090-98A	603185	6.90
Big Twin	L84-97	37090-84A	420451	13.81
4-Speed	L84-86	37090-84	609040	7.45
5-Speed	L84-96	37090-84	609040	7.45
5-Speed Big Twin	80-E84	37090-79	609037	4.66

Center

HARLEY-DAVIDSON	Year	O.E.M.	P/N	Retail
5-Speed Big Twin	90-06	37088-90	609046 ¹	7.45
5-Speed Big Twin	87-89	37088-87	609042	11.18
5-Speed Big Twin	85-86	37088-85	609041	11.18
5-Speed Big Twin	L1984	37088-84	609039	13.27
4-Speed Big Twin	84-86	37285-84	609043	10.45

¹ exc. 2006 Dyna

Right

HARLEY-DAVIDSON	Year	O.E.M.	P/N	Retail
Big Twin	91-16	37069-90	609057	21.09
4-Speed	L84-86	37089-84A	609038	6.90
5-Speed	L84-90	37089-84A	609038	6.90
5-Speed Big Twin	80-E84	37089-79	609036	4.69



EXCLUSIVE

BIKER'S CHOICE® CLUTCH ADJUSTING SCREW AND NUTS

- Made in USA



HARLEY-DAVIDSON	Year	Description	O.E.M.	P/N	Retail
FL	41-84	Screw Ball Type	37357-41	609026	3.39
FL	41-84	Screw	37357-41	603216	16.50
FL	41-84	Lock Nut	37361-41	609032	19.60
FX	71-84	Screw Ball Type	37357-41	609026	3.39
FX	71-84	Screw	37357-41	603216	16.50
FX	71-84	Lock Nut	37361-41	609032	19.60

1. Barnett Liner w/Rivets
2. Bearing Retainer Springs
3. Hub Nut Lock Tabs
4. Mainshaft Nut
5. Mainshaft Nut Oil Seal
6. Retainer with Rollers
7. Stud Nuts
8. Studs (Long)
9. Studs (Short)
10. Woodruff Keys

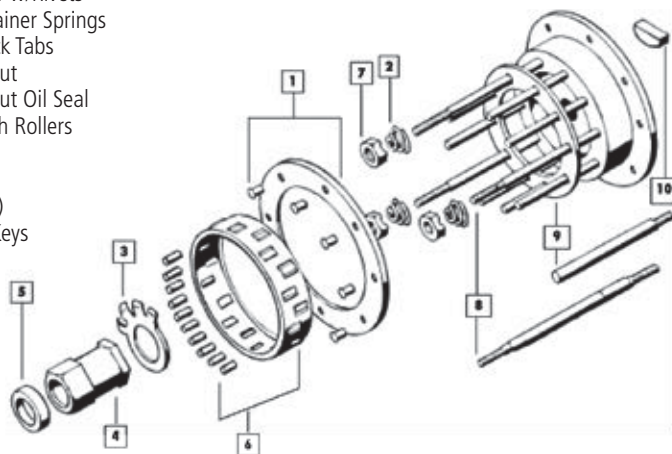

EASTERN 4-SPEED CLUTCH HUB

HARLEY-DAVIDSON	Year	Description	O.E.M	P/N	Retail
Big Twin	41-E84	Barnett Liner w/Rivets	37549-41	498038	12.65
Big Twin	44-E84	Bearing Retainer Springs	37574-44	603171	3.95
Big Twin	41-E84	Hub Nut Lock Tabs	37503-41	492681¹	8.50
Big Twin	41-E84	Mainshaft Nut	37496-65	609024	4.33
Big Twin	65-E84	Mainshaft Nut Oil Seal	12014	492484	22.50
Big Twin	41-E84	Retainer with Rollers	37567-41A	493313	27.95
Big Twin	41-E84	Stud Nuts	37581-47	609018	3.57
Big Twin	41-E84	Studs (Long)	37583-41	492706	3.95
Big Twin	41-E84	Studs (Short)	37585-41	492707	3.95
Big Twin	41-E84	Woodruff Keys	37523-15	603168²	16.50

ALTO CLUTCH HUB LINERS WITH RIVETS

- H-D®#37549-41
- Made in USA



HARLEY-DAVIDSON	Year	P/N	Retail
FL	41-84	498209	5.49
FX	71-84	498209	5.49



EXCLUSIVE

TWIN POWER CLUTCH HUB ASSEMBLY

Perfect replacement for the stock early clutch hub from Twin Power.

Includes:

- Assembled clutch hubs are complete with friction disc and rivets
- Bearing retainer with bearings, spring pressure plate and stud nuts

HARLEY-DAVIDSON	Year	P/N	Retail
FL	41-84	498209	5.49
FX	71-84	498209	5.49



482804

489601



EXCLUSIVE

TWIN POWER CLUTCH HUBS

These accurate reproductions of the Big Twin clutch hub features steel spines aluminum hub construction.

HARLEY-DAVIDSON	Year	P/N	Retail
Big Twin	07-10	482804	130.95
Big Twin	98-06	489601¹	124.95
Twin Cam	98-06	489601	124.95
Big Twin	90-97	489714	89.50
Evolution Big Twin	84-89	489599	127.95

¹ exc. 06-up Dyna

Clutch Hub Nut

HARLEY-DAVIDSON	Year	P/N	Retail
Big Twin	90-16	603184	9.51

Hub Retaining Ring

HARLEY-DAVIDSON	Year	P/N	Retail
Big Twin	90-16	410170	19.87

Clutch Hub Key

- Sold in bags of ten

HARLEY-DAVIDSON	Year	P/N	Retail
Big Twin	L84-89	603485	16.50



603184



489714



489599



410170



603485

PRIMARY DRIVE

AUDIO, VIDEO
& NAVIGATION

INDIAN
& VICTORY

WINDSHIELDS

SEATS &
SISSY BARS

LUGGAGE

SECURITY
& COVERS

TIRES &
WHEELS

BRAKES

CHASSIS

SUSPENSION

SHEET METAL

EXHAUST

FUEL & AIR
SYSTEMS

ENGINE &
OIL FILTERS

PRIMARY DRIVE

TRANSMISSION
& FINAL DRIVE

GASKETS &
HARDWARE

HANDLEBARS
& CONTROL

CABLES

FOOT
CONTROL

INSTRUMENT
& LIGHTING

ELECTRICAL

BATTERIES &
CHARGERS

TRAILERS
& RAMPS

CHEMICALS
& LUBES

TOOLS &
SUPPLIES

GENERAL
ACCESSORIES
& DISPLAY

CROSS
REFERENCE

INDEX



EXCLUSIVE

TWIN POWER CLUTCH SHELL

These are exact reproduction of the O.E.M. clutch shell. They feature hardened components.

- Includes the inner and outer ramps
- Fits 87-06 5-speed Big Twin models, or for upgrading earlier models, it comes with a coupler with clip and the three balls.

HARLEY-DAVIDSON	Year	Teeth	O.E.M.	P/N	Retail
Big Twin	07-10		37813-06A	489619	299.95
Big Twin	98-06		37707-98	489602¹	269.95
Big Twin	94-97	36	37707-94	489741	263.95
Big Twin	90-93	37	37707-90	489713	231.95
Big Twin	70-E84		37702-70A	492874	211.95
Dyna	06-10		37813-06A	489619	299.95
XLH	91-03		36790-91	489620	277.95

¹ exc. 2006 Dyna



ALL BALLS RACING REPLACEMENT CLUTCH HUB BEARING

HARLEY-DAVIDSON	Year	O.E.M.	P/N	Retail
Big Twin	90-10	37906-90	601460	24.95



EVOLUTION INDUSTRIES DIAMOND TERMINATOR CLUTCH BASKET

Precision-machined clutch basket with replaceable steel chain sprocket, bearing race, ring gear and clutch drive dogs. Accepts stock replacement clutch pack or Evolution Industries Stage-1 or D-series performance clutch. Features bolt on ring gear for easy replacement. Weighs less than O.E.M. clutch basket. Diamond tough street/strip ready.

- Includes removable inner hub for 4-speed application
- Three-year limited manufacturer's warranty
- Made in USA



HARLEY-DAVIDSON	Year	P/N	Retail
FLH, FXR, FX	70-84	411645	399.99
XL	04-16	411646¹	347.99

¹ 57 Tooth

EVOLUTION INDUSTRIES REPLACEMENT CLUTCH BASKET BEARING

- Fits Evolution Industries Diamond Terminator Clutch Baskets
- Made in USA



P/N	Retail
411654	64.99



RIVERA PRIMO STARTER RING GEARS

For chain drive clutch baskets. Manufactured from high quality steel to exacting standards.

66-Tooth with Bolts

HARLEY-DAVIDSON	Year	Mfg/N	P/N	Retail
FLH, FLT, FXST, FLST, FXD, FXR	90-97	2171-0011	060493	81.50

102-Tooth with Bolts

HARLEY-DAVIDSON	Year	Mfg/N	P/N	Retail
FLH, FLT, FXST, FLST, FXD, FXR	94-97	2171-0005	060491	111.50
FLH, FLT, FXST, FLST, FXD	98-06	2171-0006	060492¹	113.95

Pinion Gears

HARLEY-DAVIDSON	Year	Mfg/N	P/N	Retail
Big Twin	94-06	1186-0001	060562¹	39.95
Big Twin	94-06	1186-0022	060564¹	54.50

¹ Exc. 2006 Dyna



482453



482452



482523

EXCLUSIVE

TWIN POWER STARTER RING GEARS

These gears are black oxide-coated and heat-treated for maximum strength to give you the best performance possible.

- Includes six bolts

Starter Ring

- High-quality replacement ring gears for 65-06 Big Twin models, except 2006 Dyna.

HARLEY-DAVIDSON	Year	Teeth	P/N	Retail
Big Twin	98-06	102	482454 ²	69.95
Big Twin	98-06	66	482455 ^{1,2}	69.95
Big Twin	94-97	102	482453	69.95
Big Twin	90-93	66	482452	69.95
Big Twin	65-E84		492875	66.95

¹ Requires use of P/N 482523 nine tooth pinion gear, sold separately

² Except 2006 Dyna

9T Pinion Gear

- Fits 90-06 models with 66T ring gear, except 2006 Dyna.

HARLEY-DAVIDSON	Year	Teeth	P/N	Retail
Big Twin	98-06	66	482523	19.95
Big Twin	90-93	66	489621	17.95

10T Pinion Gear

- Fits 94-06 models with 102T ring gear, except 2006 Dyna.

HARLEY-DAVIDSON	Year	Teeth	P/N	Retail
Big Twin	94-06	102	489622	17.95



EVOLUTION INDUSTRIES STARTER RING GEARS

O.E.M. style. 66 tooth ring gears are precision-machined, case-hardened and black oxide coated. 102 tooth ring gears are manufactured from 4130 steel and heat-treated for maximum strength.

- Made in USA



HARLEY-DAVIDSON	Year	Teeth	P/N	Retail
Big Twin	98-06	102	411613 ¹	99.99
Big Twin	94-97	102	411609	99.99
Big Twin	90-93	66	411608	104.99
Big Twin	65-84	66	411648	104.99
Big Twin	65-84	66 Weld On	411647	104.99

¹ exc. 2006 Dyna



EVOLUTION INDUSTRIES SUPER TOOTH STARTER RING GEAR

Made from aircraft quality 8620 steel. Entirely hardened by carburization followed by an oil bath, as opposed to water quench. Black oxide finish. Manufacturer recommends replacing pinion each time the ring gear is replaced.

- Made in USA



HARLEY-DAVIDSON	Year	P/N	Retail
FLH	07-16	411638	158.99
FXST, FLST	07-16	411638	158.99
FXD	06-16	411638	158.99



EVOLUTION INDUSTRIES SPROCKET RING GEAR

Raises RPMs to eliminate lugging of motor and achieve maximum performance. Precision-machined sprocket and ring gear. Manufactured from aircraft-quality steel, heat-treated and ground to specifications to insure maximum strength. Designed to fit stock O.E.M. chain baskets.

Stock 46 tooth 1.352 gear ratio; 4th gear 70 MPH @ 3620 RPM; 5th gear 70 MPH @ 3042 RPM; 6th gear 70 MPH @ 2570 RPM; 6th gear 102 MPH @ 3765 RPM;

49 tooth 1.441 gear ratio; 4th gear 70 MPH @ 3816 RPM; 5th gear 70 MPH @ 3363 RPM; 6th gear 70 MPH @ 2786 RPM; 6th gear 102 MPH @ 4028 RPM

- Includes mounting hardware
- 49 tooth kit includes custom primary chain
- Made in USA
- Three-year limited manufacturer's warranty

Note: Drilling of clutch basket .1750 deep necessary with optional counter bore tool, sold separately



HARLEY-DAVIDSON	Year	Teeth	P/N	Retail
Touring Models	07-16	49	411631	515.99
Big Twin	07-16	46	411629	420.99
FXST, FLST	07-10	49	411630	515.99
FXD	06-16	46	411629	420.99
FXD	06-16	49	411630	515.99

Replacement Jackshaft

ON PAGE 1703

AUDIO, VIDEO & NAVIGATION

INDIAN & VICTORY

WINDSHIELDS

SEATS & SISSY BARS

LUGGAGE

SECURITY & COVERS

TIRES & WHEELS

BRAKES

CHASSIS

SUSPENSION

SHEET METAL

EXHAUST

FUEL & AIR SYSTEMS

ENGINE & OIL FILTERS

PRIMARY DRIVE

TRANSMISSION & FINAL DRIVE

GASKETS & HARDWARE

HANDLEBARS & CONTROL

CABLES

FOOT CONTROL

INSTRUMENT & LIGHTING

ELECTRICAL

BATTERIES & CHARGERS

TRAILERS & RAMPS

CHEMICALS & LUBES

TOOLS & SUPPLIES

GENERAL ACCESSORIES & DISPLAY

CROSS REFERENCE

INDEX

PRIMARY DRIVE



EVOLUTION INDUSTRIES COMPLETE RING GEAR KIT

Made from aircraft quality 8620 steel. Entirely hardened by carburization followed by an oil bath, as opposed to water, quench.

- Black oxide finish
- Includes a replacement starter clutch and pinion gear assembly
- Made in USA



HARLEY-DAVIDSON	Year	P/N	Retail
FLH	07-16	411655	247.99
FXST, FLST	07-16	411655	247.99
FXD	06-16	411655	247.99



411610



411616

EVOLUTION INDUSTRIES CONVERSION KITS

Precision machined and case hardened. Black oxide coated and made from 8620 steel. Heat-treated for maximum strength.

- Kits include starter ring gear, a pinion gear and 6 bolts
- Made in USA

Note: Does not interchange with O.E.M. unless used as a kit



HARLEY-DAVIDSON	Year	Teeth	P/N	Retail
Big Twin	98-06	84	411617	145.99
Big Twin	98-06	66	411614	139.99
Big Twin	94-97	84	411616	145.99
Big Twin	94-97	66	411610	154.99
Big Twin	90-93	84	411615	145.99
Big Twin	90-93	102	411649	145.99



RIVIERA PRIMO RING GEAR CONVERSION KITS FOR CHAIN DRIVES

66-tooth conversion kits to convert existing 102-tooth ring and pinion combinations to a 66-tooth ring gear with 9-tooth pinion gear.

- Includes 66-T ring gear with bolts and 9T pinion gear
- Made in USA



HARLEY-DAVIDSON	Year	P/N	Retail
Big Twin	99-06	060494¹	125.95
Big Twin	94-97	060495	131.95

¹ exc. 2006 Dyna

EVOLUTION INDUSTRIES COMPLETE STARTER RING GEAR CONVERSION KIT

Manufactured from aircraft quality steel, heat-treated and ground to specifications to ensure maximum strength. Designed to fit stock O.E.M. clutch baskets.

- Made in USA
- Three-year limited manufacturer's warranty

Includes:

- Jackshaft bolt
- Spring
- Pinion gear
- Thrust washer
- Lock plate
- Coupling
- Output shaft coupling
- Shaft
- Retaining ring
- Mounting bolts



411623



HARLEY-DAVIDSON	Year	Teeth	P/N	Retail
Big Twin	98-06	66	411623²	220.99
Big Twin	98-06	84	411628²	229.99
Big Twin	98-06	102	411625²	229.99
Big Twin	94-97	66	411622	243.99
Big Twin	94-97	84	411627	229.99
Big Twin	90-97	102	411624	229.99
Big Twin	90-93	84	411626¹	229.99

¹ Check inner primary for ring gear clearance

² exc. 2006 Dyna

EVOLUTION INDUSTRIES PINION GEARS

High-strength, precision manufactured from aircraft-quality steel. Heat-treated. Black oxide coated for longer life.

- Three-year limited manufacturer's warranty
- Made in USA

Note: Evolution Industries recommends changing pinion gear when changing ring gear or chain basket.



Stock

HARLEY-DAVIDSON	Year	Teeth	P/N	Retail
Big Twin	94-06	10	411621¹	67.99
Big Twin	89-93	9	411618	67.99

84 Tooth Conversion

HARLEY-DAVIDSON	Year	Teeth	P/N	Retail
Big Twin	94-06	10	411620¹	67.99
Big Twin	90-93	9	411619	67.99

¹ exc. 2006 Dyna



RIVIERA PRIMO 84 TOOTH RING GEAR CONVERSION KIT

Stronger than a 102-tooth ring gear and requires less effort than a 66-tooth.

- Starter pinion gear and mounting hardware included
- Drilling required
- Made in the USA

Note: For primary chain drives only



HARLEY-DAVIDSON	Year	P/N	Retail
FLH	90-93	060161	137.95
FXST, FLST	90-93	060161	137.95
FXD	91-93	060161	137.95
FXR	90-93	060161	137.95





COMPU-FIRE® 1084 GEAR SET

Engineered to increase the starter motor torque by lowering the gear ratio of the pinion gear to the clutch ring gear. Use as replacements for the weak 10:102 ratio gear sets, which are prone to breaking on late model Big Twins.

HARLEY-DAVIDSON	Year	P/N	Retail
Big Twin	94-97	603257	166.40
Big Twin	98-06	603258¹	166.40

¹ exc. 2006 Dyna



NEW! EXCLUSIVE

TWIN POWER™ PRIMARY DRIVE LOCKING TOOL

Locks primary to allow removal of motor sprocket or clutch nut.

- For all Big Twin and XL models

P/N	Retail
487055	24.50



JIMS® GASKET LOCATOR TOOL

Primary cover, cam cover and transmission end cover gaskets are just a few of the possible applications.

- Use on all models with 1/4"-20 threaded gasket surface mounting holes
- Three-piece set

P/N	Retail
461120	34.50



JIMS® ALL PRIMARY DRIVE LOCKING TOOL

Use on all primaries between front primary chain and motor sprocket.

- Made out of black Delrin
- Five speed only

P/N	Retail
494964	53.50



JIMS® PRIMARY LOCKING BARS

Use to lock primary for service work.

HARLEY-DAVIDSON	Year	P/N	Retail
FLH, FLT	07-16	495174	56.25
FL, FLH	48-78	491828	30.10
FXST, FLST	07-16	495138	53.50
FXD	06-16	495138	53.50
FXR	82-94	491829	30.10
XL1200	04-16	467975	36.50
XL883	91-06	491830	30.10



JIMS® PRIMARY COVER INSPECTION PLUG TOOL

This tool is used to remove and install the O.E.M.-style primary cover clutch adjuster access plug and filler plug without distorting the plug's slot.

HARLEY-DAVIDSON	Year	P/N	Retail
XL, K	54-90	498642	19.49



COLONY PRIMARY COVER PLUG WRENCH

Used to remove and install clutch adjusting and oil filler plugs on all K and Sportster primary covers.

- Zinc-plated

HARLEY-DAVIDSON	Year	P/N	Retail
XL	71-90	044305	13.99



PRIMARY DRIVE



JIMS® INNER PRIMARY COVER BEARING AND SEAL INSTALLER/REMOVER TOOL

Designed to safely remove and install the inner primary bearing H-D® #9135 without any damage to the new bearing. This is done by pushing on the outer perimeter of the bearing. Also removes and installs inner primary seal, H-D® #12052A, which is the bearing and seal that the transmission mainshaft passes through.

HARLEY-DAVIDSON	Year	Type	P/N	Retail
FLH	85-16	Bearing/Seal Tool	461245	216.50
FXST	84-16	Bearing/Seal Tool	461245	216.50
FLST	86-15	Bearing/Seal Tool	461245	216.50
FXD	91-16	Bearing/Seal Tool	461245	216.50
FXR	82-94	Bearing/Seal Tool	461245	216.50
FLH	07-16	Upgrade Installer	461246	71.50
FXST	07-16	Upgrade Installer	461246	71.50
FLST	07-16	Upgrade Installer	461246	71.50
FXD	06-16	Upgrade Installer	461246	71.50
FLH	07-16	Upgrade Remover	461247	25.50
FXST	07-16	Upgrade Remover	461247	25.50
FLST	07-16	Upgrade Remover	461247	25.50
FXD	06-16	Upgrade Remover	461247	25.50



JIMS® OUTER PRIMARY BEARING REMOVER

- Fits Sportster and Big Twin
- Made in USA



P/N	Retail
490716	175.05



JIMS® STARTER JACKSHAFT SEAL INSTALLER TOOL

Designed to easily align and install the starter jackshaft seal H-D® #12066 without distorting or damaging the seal. The seal is located in the upper part of the inner primary of Big Twins.

HARLEY-DAVIDSON	Year	P/N	Retail
FLH	94-06	461123	122.55
FXST, FLST	94-06	461123	122.55
FXD	94-05	461123	122.55



JIMS® STARTER RING GEAR RIVET FIXTURE TOOL

Designed to remove the starter ring gear rivets from Big Twin clutch shells to install performance starter ring gears.

HARLEY-DAVIDSON	Year	P/N	Retail
FLH	90-06	461125	442.85
FXST, FLST	90-06	461125	442.85
FXD	91-05	461125	442.85
FXR	90-94	461125	442.85



MOTION PRO® CLUTCH SPRING COMPRESSOR

Used to release the clutch spring.

- Sold as a kit

HARLEY-DAVIDSON	Year	P/N	Retail
FLH	90-97	056294	66.99
FXST, FLST	90-97	056294	66.99
FXD	91-97	056294	66.99
FXR	90-94	056294	66.99
XL	91-06	056294	66.99
BUELL			
Buell	97-03	056294	66.99



BARNETT CLUTCH SPRING TOOLS

These tools make it easy to remove and install retainer ring.

HARLEY-DAVIDSON	Year	P/N	Retail
Big Twin	90-10	498008	91.95
XL	91-16	498008	91.95
XL	84-90	498009	50.50



NEW! EXCLUSIVE

TWIN POWER™ CLUTCH SPRING COMPRESSOR TOOL

Allows easy snap ring removal for clutch replacement.

HARLEY-DAVIDSON	Year	P/N	Retail
FLH, FLT, FXST, FLST, FXD	90-97	487054	62.95
XL	91-16	487054	62.95



JIMS® CLUTCH ALIGNMENT TOOL

Use to align the clutch plates during assembly of the clutch basket.

HARLEY-DAVIDSON	Year	P/N	Retail
V-Rod	02-14	498641	36.70



JIMS® CLUTCH SPRING COMPRESSOR

Use to remove and install clutch components.

HARLEY-DAVIDSON	Year	P/N	Retail
XL	71-E84	496104	128.25



JIMS® CLUTCH HUB HOLDER

Use to lock the clutch hub assembly in place when removing or installing the clutch hub nut.

- 02-07 V-Rod models

P/N	Retail
498644	222.00



JIMS® CLUTCH HUB PULLER TOOL

Can be used on 3, 5 and 10 finger clutch hubs and 45 in. clutch hubs. Works on Big Twin alternator cover, motor sprocket, Sportster transmission sprocket and Early/Late clutches.

P/N	Retail
494967	97.75



JIMS® CLUTCH SPRING COMPRESSOR TOOL

Use to release clutch spring for ease of retainer ring removal and installation.

HARLEY-DAVIDSON	Year	P/N	Retail
Big Twin	90-97	496111	117.65

Nut for Clutch Spring Compressor Tool

HARLEY-DAVIDSON	Year	P/N	Retail
XL	91-17	496157	49.75

BUELL	Year	P/N	Retail
Buell	91-16	496157	49.75



JIMS® CLUTCH SPRING TOOL

Use to release the clutch spring tension for disassembly.

HARLEY-DAVIDSON	Year	P/N	Retail
XL	L84-90	494980	75.75

BUELL	Year	P/N	Retail
Buell	87-90	494980	75.75



JIMS® CLUTCH ASSEMBLY SERVICE TOOL

Safely disassembles and assembles the clutch shell assembly. Easily removes and installs the clutch hub from its bearing. Safely removes and installs the clutch shell ball bearing H-D®#37906-90 without any damage to the new bearing; this is done by pushing on the outer perimeter of the bearing.

HARLEY-DAVIDSON	Year	P/N	Retail
FLH	90-16	461130	423.65
FXST, FLST	90-16	461130	423.65
FXD	91-16	461130	423.65
FXR	90-94	461130	423.65



JIMS® CLUTCH HUB PULLERS

Late-style puller is bored to accept end of clutch pushrod eliminating the removal of the transmission end cover on vehicles equipped with late-style throw out bearing.

HARLEY-DAVIDSON	Year	P/N	Retail
EL, FL, FLH	36-90	496090	93.90
FXST	84-90	496090	93.90
FLST	86-90	496090	93.90
FXR	82-90	496090	93.90

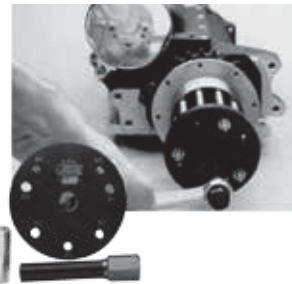

AUDIO, VIDEO & NAVIGATION

INDIAN & VICTORY

WINDSHIELDS

SEATS & SISSY BARS

LUGGAGE

SECURITY & COVERS

TIRES & WHEELS

BRAKES

CHASSIS

SUSPENSION

SHEET METAL

EXHAUST

FUEL & AIR SYSTEMS

ENGINE & OIL FILTERS

PRIMARY DRIVE

TRANSMISSION & FINAL DRIVE

GASKETS & HARDWARE

HANDLEBARS & CONTROL

CABLES

FOOT CONTROL

INSTRUMENT & LIGHTING

ELECTRICAL

BATTERIES & CHARGERS

TRAILERS & RAMPS

CHEMICALS & LUBES

TOOLS & SUPPLIES

GENERAL ACCESSORIES & DISPLAY

CROSS REFERENCE

INDEX

PRIMARY DRIVE



JIMS® ULTIMATE CLUTCH ADJUSTING TOOL

Imagine grabbing just one tool for a clutch adjustment, instead of three or four separate tools that don't always work well. No more open end wrenches that don't fit due to awkward angles, or multiple attempts to lock the jam nut and adjuster screw in the correct position. JIMS® new clutch tool allows the technician to quickly and accurately tighten the jam nut without changing the adjuster position. The custom socket driver allows the hex key to work through the driver and the ergonomic handle stores the key when not in use. This JIMS tool is for all Big Twins 1985 to present, including most aftermarket lock up and slipper clutches.

P/N	Retail
461255	65.50



NEW!

JIMS® COMPENSATOR BOLT TORX SOCKET

Harley-Davidson® recently changed the compensating sprocket retaining fastener to an internal drive, very large Torx® type bolt. The driver/socket for this bolt can be difficult to find and most likely is not in your tool box. Often it can only be purchased in an expensive set. Don't be caught stranded, JIMS now offers a quality socket/driver for this application priced affordably and sold individually.

HARLEY-DAVIDSON	Year	P/N	Retail
FLH, FLT, FXST, FLST, FXD	14-16	467983	14.50



NEW!

BARNETT SCORPION CLUTCH HUB PULLER

Made from billet aluminum with 7/16" hex bolt, a protection cap and 6 SHCS. Easy-to-use; won't damage main shaft.

- Fits all Scorpion hubs (except 71-83 Ironhead Sportsters)

P/N	Retail
498648	82.45



RIVERA PRIMO HUB REMOVER TOOL

For tapered shaft. Removes hub from transmission mainshaft.

P/N	Retail
060587	32.54



RIVERA PRIMO CLUTCH HUB PULLER

Quickly attaches to any Pro-Clutch or Rivera Primo belt drive diaphragm-spring style clutch hub. Allows for easy clutch hub removal.

- Includes puller, center bolt and four nuts

Note: For use with Primo primary belt drive units only.

HARLEY-DAVIDSON	Year	P/N	Retail
EL, FL, FLH	36-90	060579	86.74
FXST	84-90	060579	86.74
FLST	86-90	060579	86.74
FXR	82-90	060579	86.74



RIVERA PRIMO CLUTCH HUB TOOL

Engages and holds clutch hub splines. Allows for correct torque specifications to be applied to clutch hub nut (left-hand thread). Use when installing or removing a Pro-Clutch or Rivera Primo belt drive.

- Works with all models of Rivera Primo belt drives and also on all Rivera Primo Pro-Clutch Baskets

P/N	Retail
060574	16.50



GARDNER-WESTCOTT CLUTCH DISASSEMBLY WASHER

Easy-to-use, remove clutch pushrod adjusting screw lock nut, place compressor over screw, replace nut and tighten. Tightening relieves tension on the clutch springs, for easy removal and installation of stud nuts.

HARLEY-DAVIDSON	Year	P/N	Retail
FLH	41-E84	041430	4.95
FX	71-E84	041430	4.95